

Convex

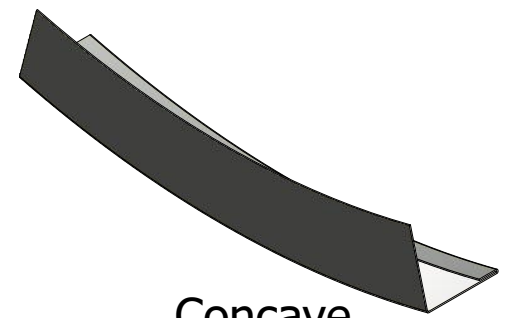

Concave

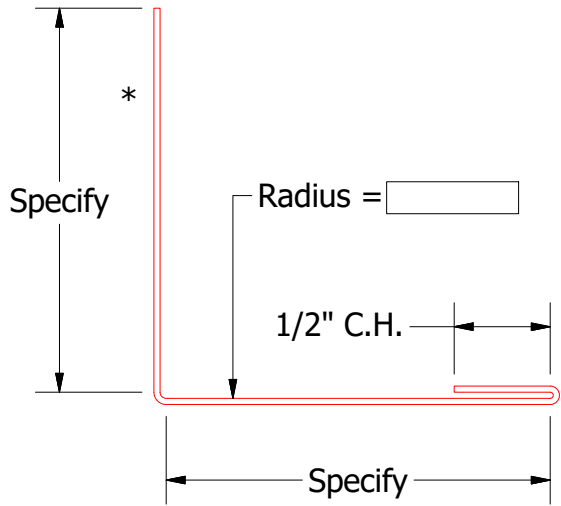

Order #

Concave:

Convex:

Material

Alum 24 ga 55% Al-Zn alloy coated steel with acrylic coating

Finish:

Color:

Trim Length:

Number of Pieces:

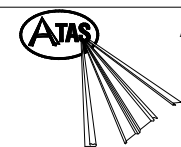

ATAS INTERNATIONAL, INC
 Allentown PA
 610-395-8445
 Mesa AZ
 480-558-7210

Note: * denotes color side.
 Note: Trims shown as Standard, Job Specific Dimensions may alter Final Product Design.

REV. NO.	DATE	DESCRIPTION OF REVISION	BY	APP
01	6/28/2022	Added Final Product Design Disclaimer	KRK	

TITLE Vaulted Trim Order Sheet - Angle Trim		
DWG. NO.	DR KRK	DATE 8/6/2019
MATERIAL	APP	DATE
SH. SIZE A	SCALE X:X	

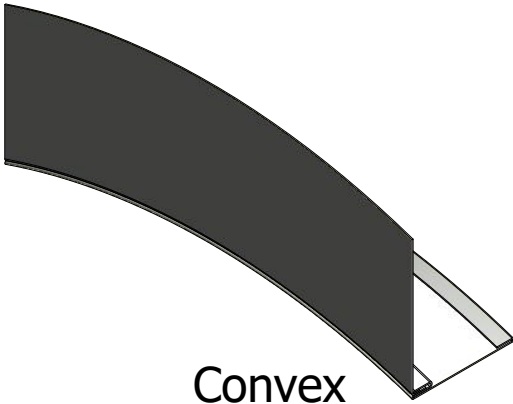

Convex

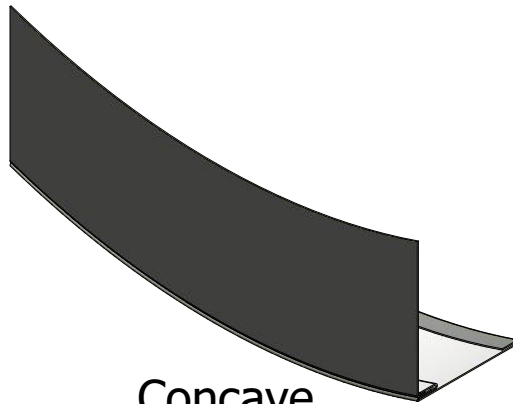

Concave

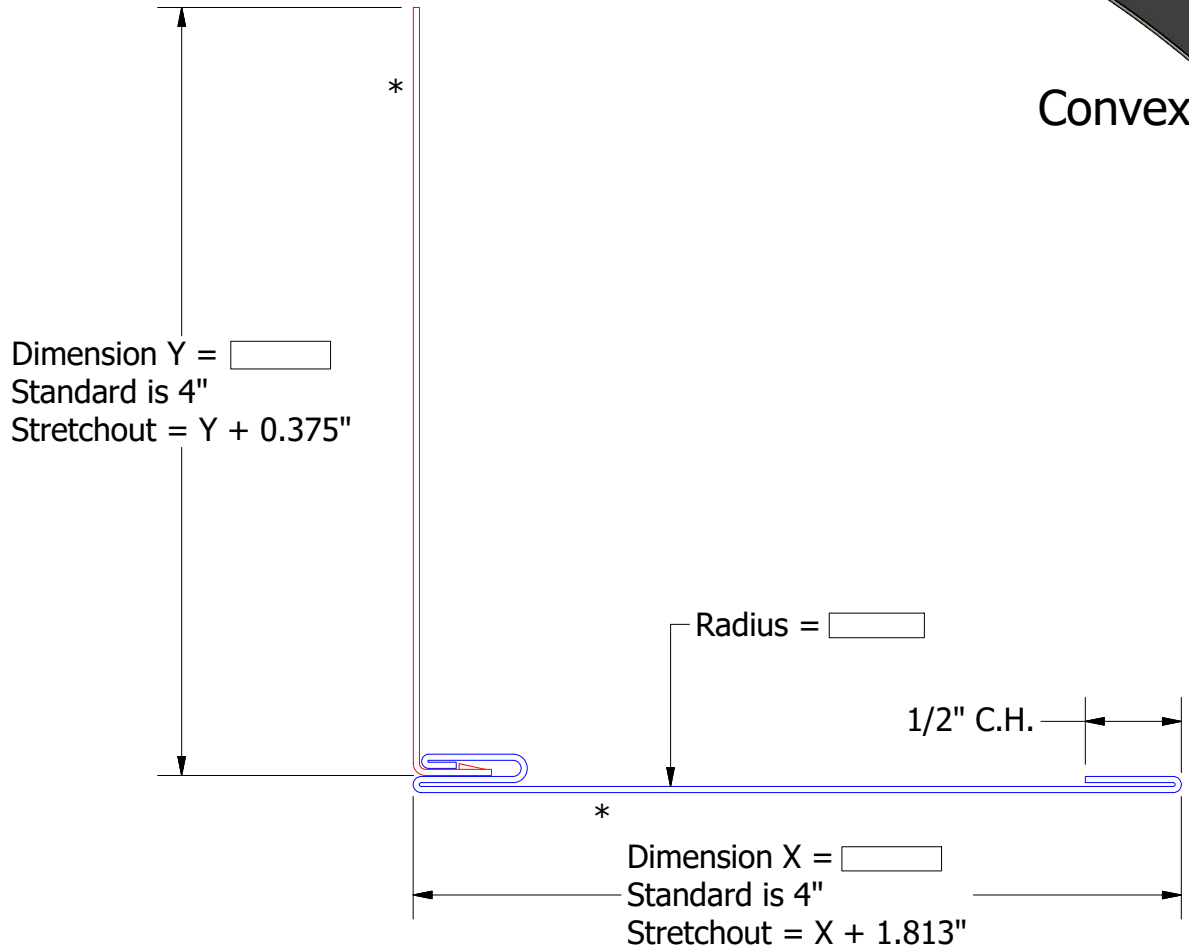

Note: * denotes color side.
 Note: Trims shown as Standard, Job Specific Dimensions may alter Final Product Design.

Note: Minimum of 1.625" for X or 1/2" Closed Hem will be omitted.

Order #

Concave:

Convex:

Material
 Alum 24 ga 55% Al-Zn alloy coated steel with acrylic coating

Finish:

Color:

Trim Length:

Number of Pieces:



ATAS INTERNATIONAL, INC
 Allentown PA
 610-395-8445
 Mesa AZ
 480-558-7210

REV. NO.	DATE	DESCRIPTION OF REVISION	BY	APP	TITLE	DR	PJR	DATE
02	6/28/2022	Added Final Product Design Disclaimer	KRK		Vaulted Trim Order Sheet - Fascia Trim			03-20-14
01	7/31/2019	Added Galv + to Material Offering	KRK					

DWG. NO.	SH. SIZE	SCALE
	A	X:X

