

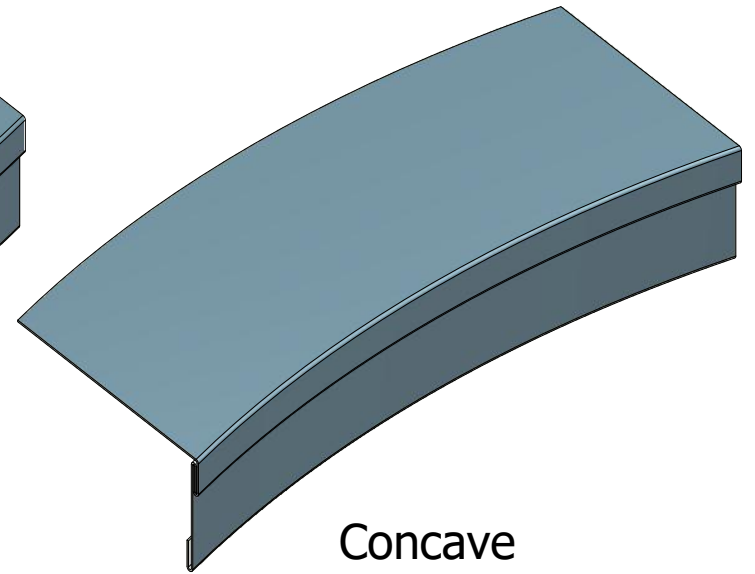

Convex

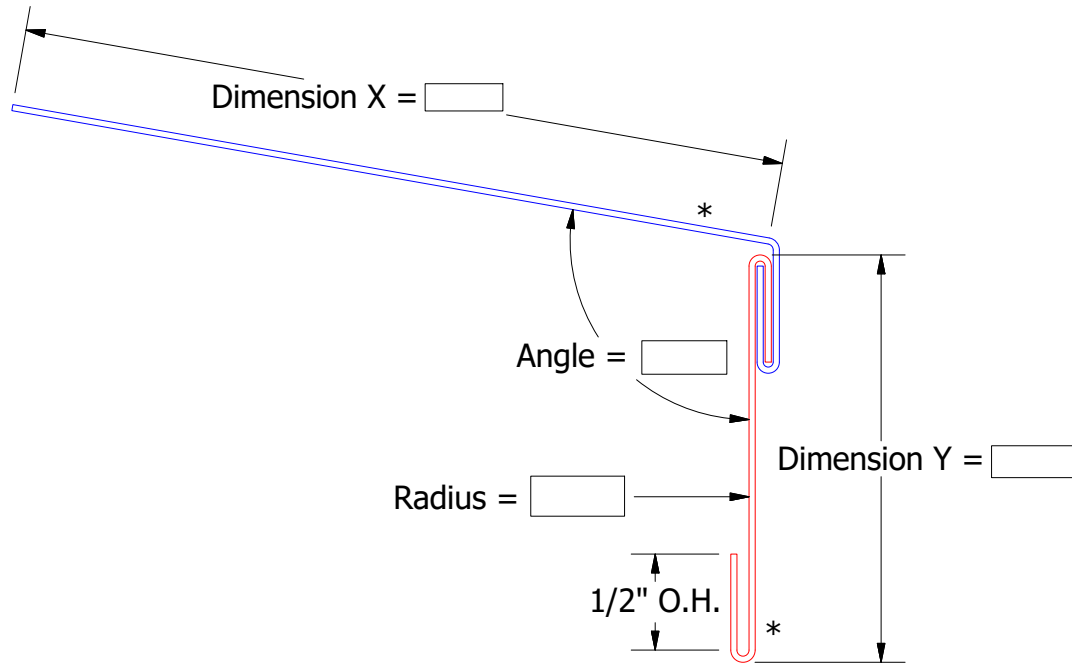

Concave



Order #

Concave: 

Convex: 

Material

Alum 24 ga 55% Al-Zn alloy coated steel with acrylic coating

Finish:

Color:

Trim Length:

Number of Pieces:



ATAS INTERNATIONAL, INC
 Allentown PA
 610-395-8445
 Mesa AZ
 480-558-7210

Note: * denotes color side.

Note: Trims shown as Standard, Job Specific Dimensions may alter Final Product Design.

				TITLE		Radius Trim Order Sheet - Window Sill	
				DWG. NO.		DR	DATE
						KRK	12/19/2019
				MATERIAL		APP	DATE
01	6/28/2022	Added Final Product Design Disclaimer	KRK				
REV. NO.	DATE	DESCRIPTION OF REVISION	BY	APP	SH. SIZE	A	SCALE
							X:X