

Convex

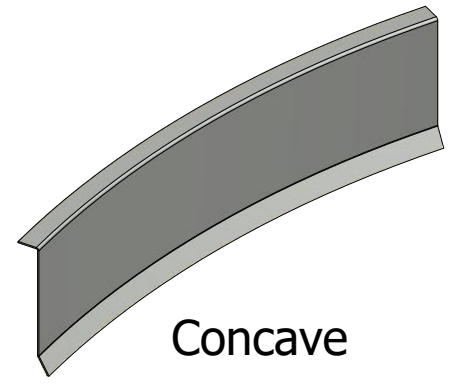

Concave

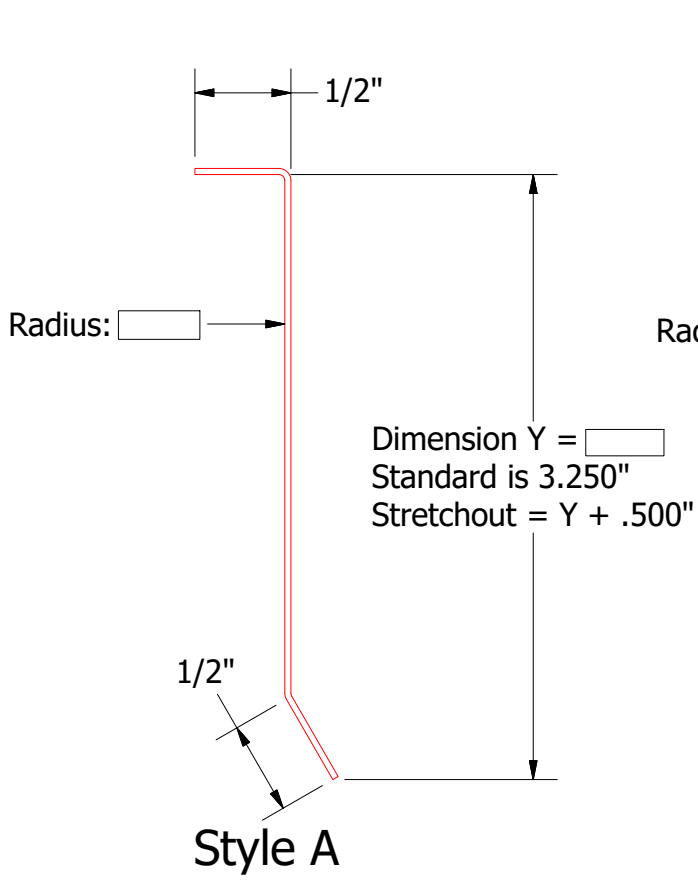

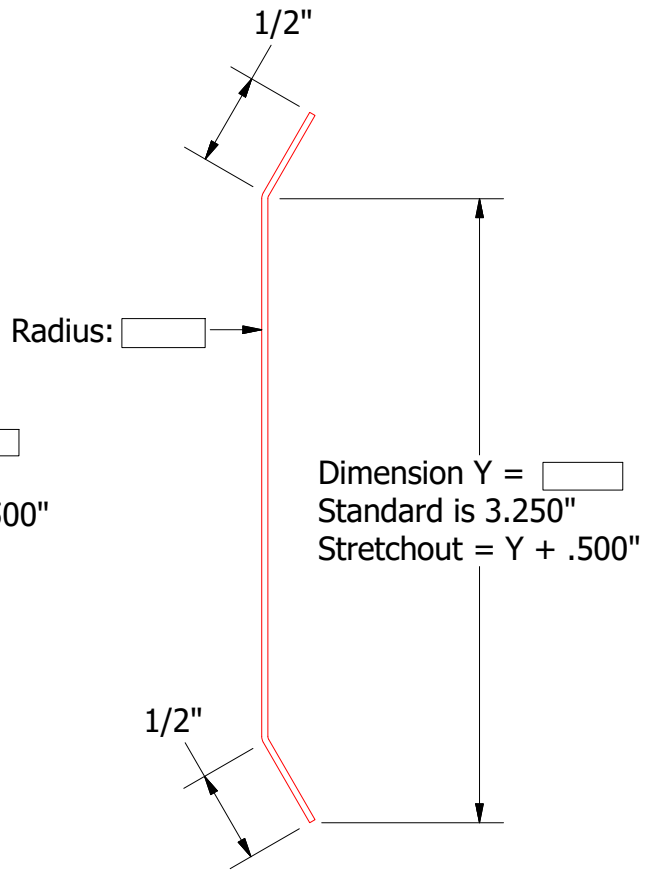

Style A



Style B

Order #

Concave:  

Convex:  

Material

Alum  24 ga 55% Al-Zn alloy coated steel with acrylic coating

Finish:

Color:

Trim Length:

Number of Pieces:

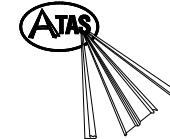

ATAS INTERNATIONAL, INC  
Allentown PA  
610-395-8445  
Mesa AZ  
480-558-7210

Note: \* denotes color side.  
Note: Trims shown as Standard, Job Specific Dimensions may alter Final Product Design.

				TITLE Radius Trim Order Sheet - Counterflashing	
				DWG. NO.	DR KRK DATE 7/30/2019
				MATERIAL	APP DATE
01	6/28/2022	Added Final Product Design Disclaimer	KRK	SH. SIZE A	SCALE X:X
REV. NO.	DATE	DESCRIPTION OF REVISION	BY	APP	