

16" - 24" O.C. Max
(depending on required PSF)

8" - 12" O.C. Max
(depending on required PSF)

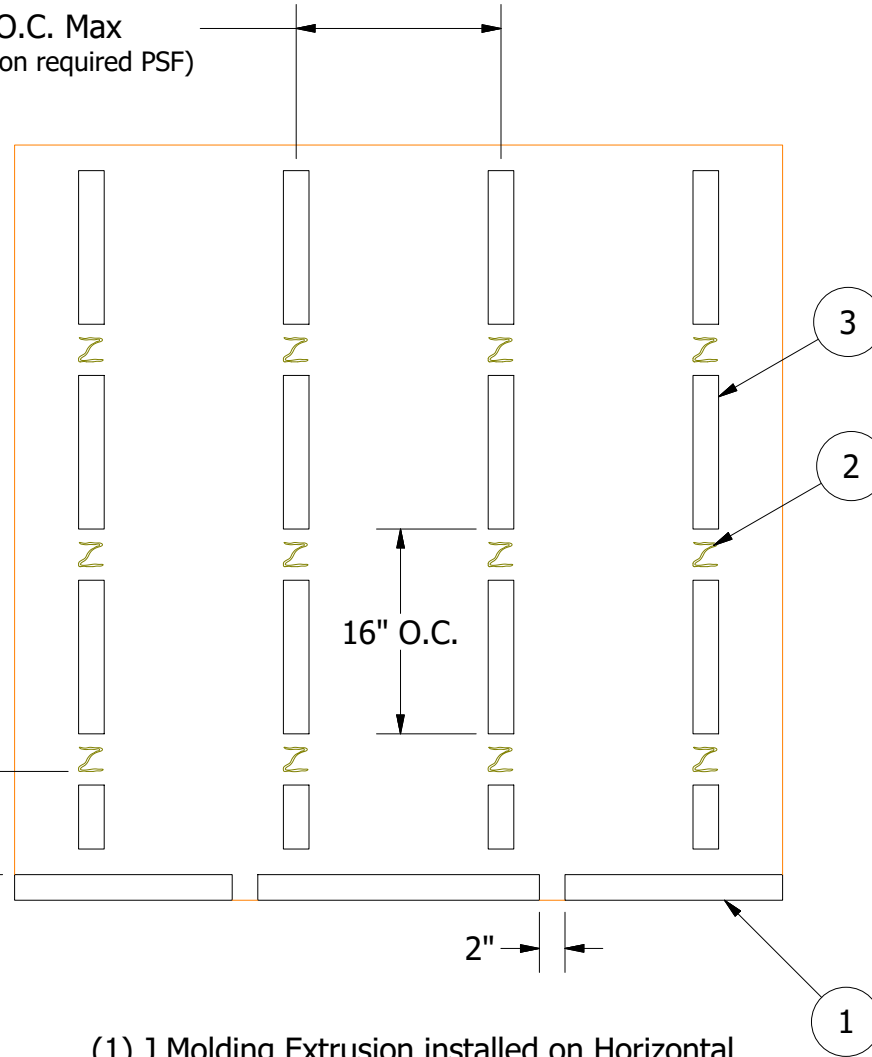

(1) J Molding Extrusion installed on Horizontal Foam Tape 2" min. gap at 24" O.C.

(2) Panel Adhesive applied 16"-24" O.C. Horizontally and 16" O.C. Vertically.

(3) Foam Tape installed Vertically in between Panel Adhesive.

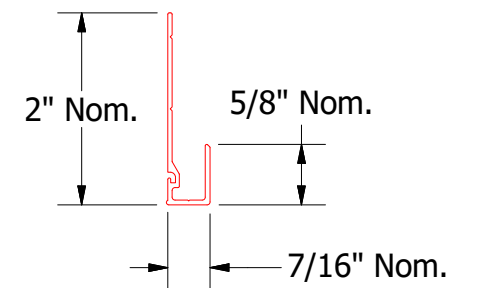
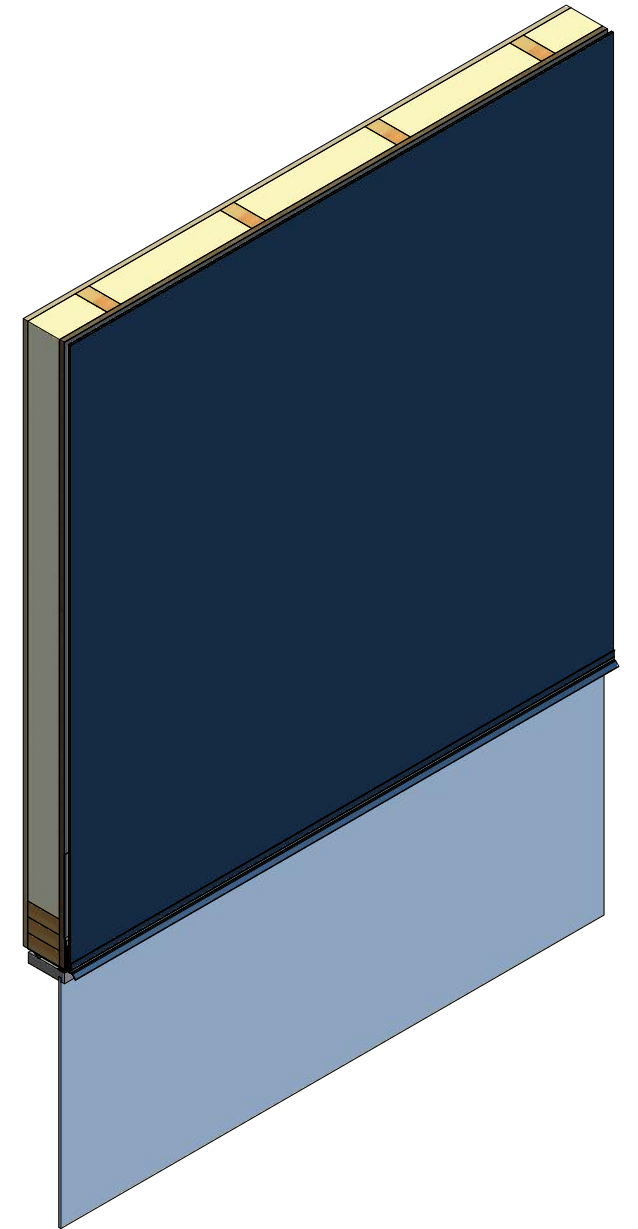

J Molding Extrusion

SterraCore Panel

TITLE				SterraCore Head Detail			
DWG. NO.		DR		DATE		4/12/2022	
		APP		DATE			
MATERIAL		SH. SIZE		SCALE		X:X	
REV. NO.		DATE		DESCRIPTION OF REVISION		BY APP	

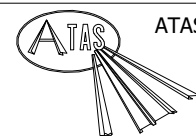

ATAS INTERNATIONAL, INC
Allentown PA
610-395-8445
Mesa AZ
480-558-7210