

Note: * denotes color side.

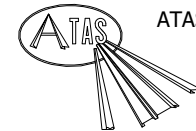

ATAS INTERNATIONAL, INC
 Allentown PA
 610-395-8445
 Mesa AZ
 480-558-7210

				TITLE		BWC Panel Profile Detail	
				DWG. NO.		DR	DATE
						KRK	1/19/2022
				MATERIAL		APP	DATE
						SH. SIZE	SCALE
						B	X:X
REV. NO.	DATE	DESCRIPTION OF REVISION	BY	APP			

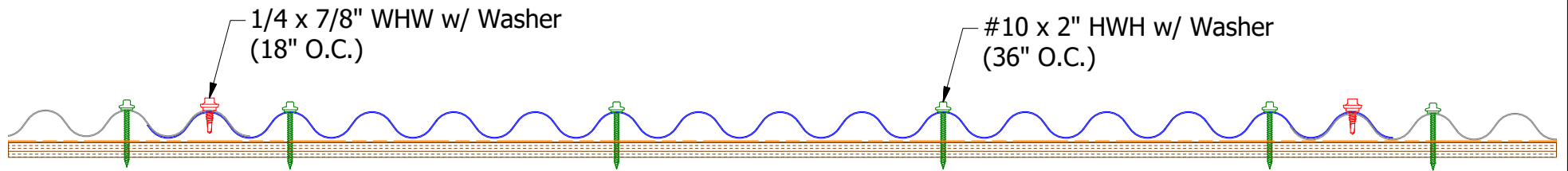
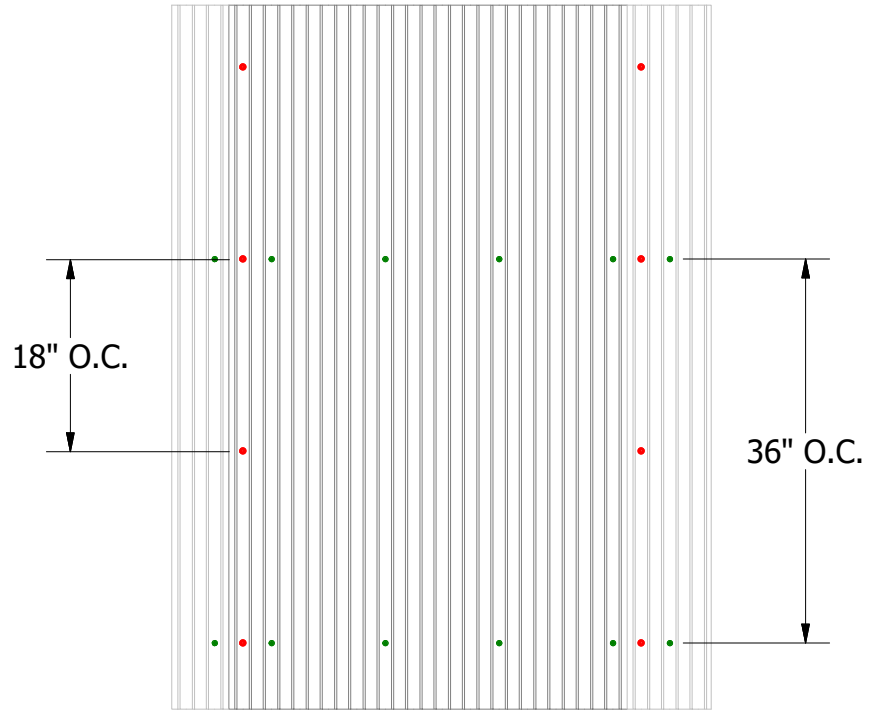

ATAS INTERNATIONAL, INC
 Allentown PA
 610-395-8445
 Mesa AZ
 480-558-7210

TITLE **BWC Roof Fastening Detail**

REV. NO.	DATE	DESCRIPTION OF REVISION	BY	APP

DWG. NO.	DR	DATE
	KRK	3/3/2020
MATERIAL	APP	DATE
	SH. SIZE	SCALE
	A	X:X

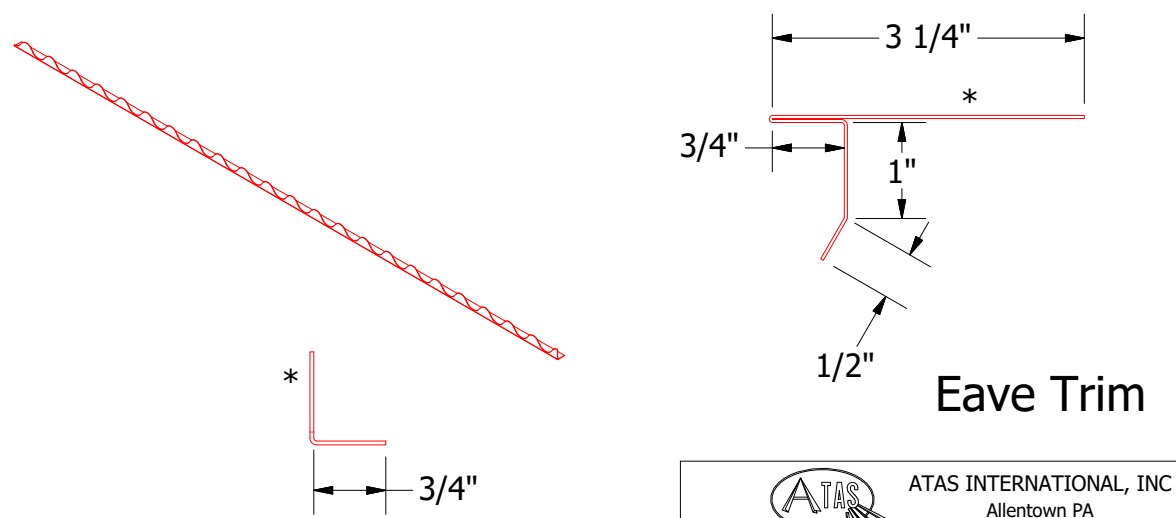
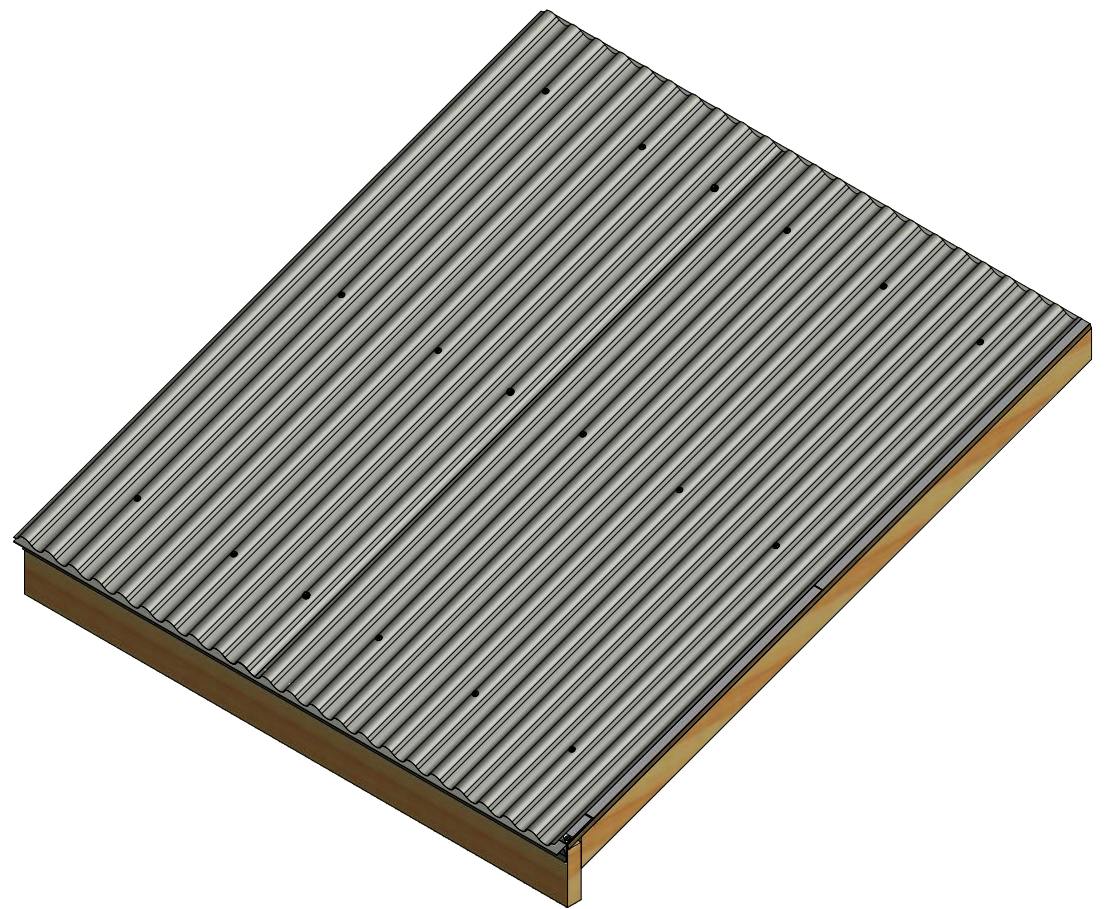
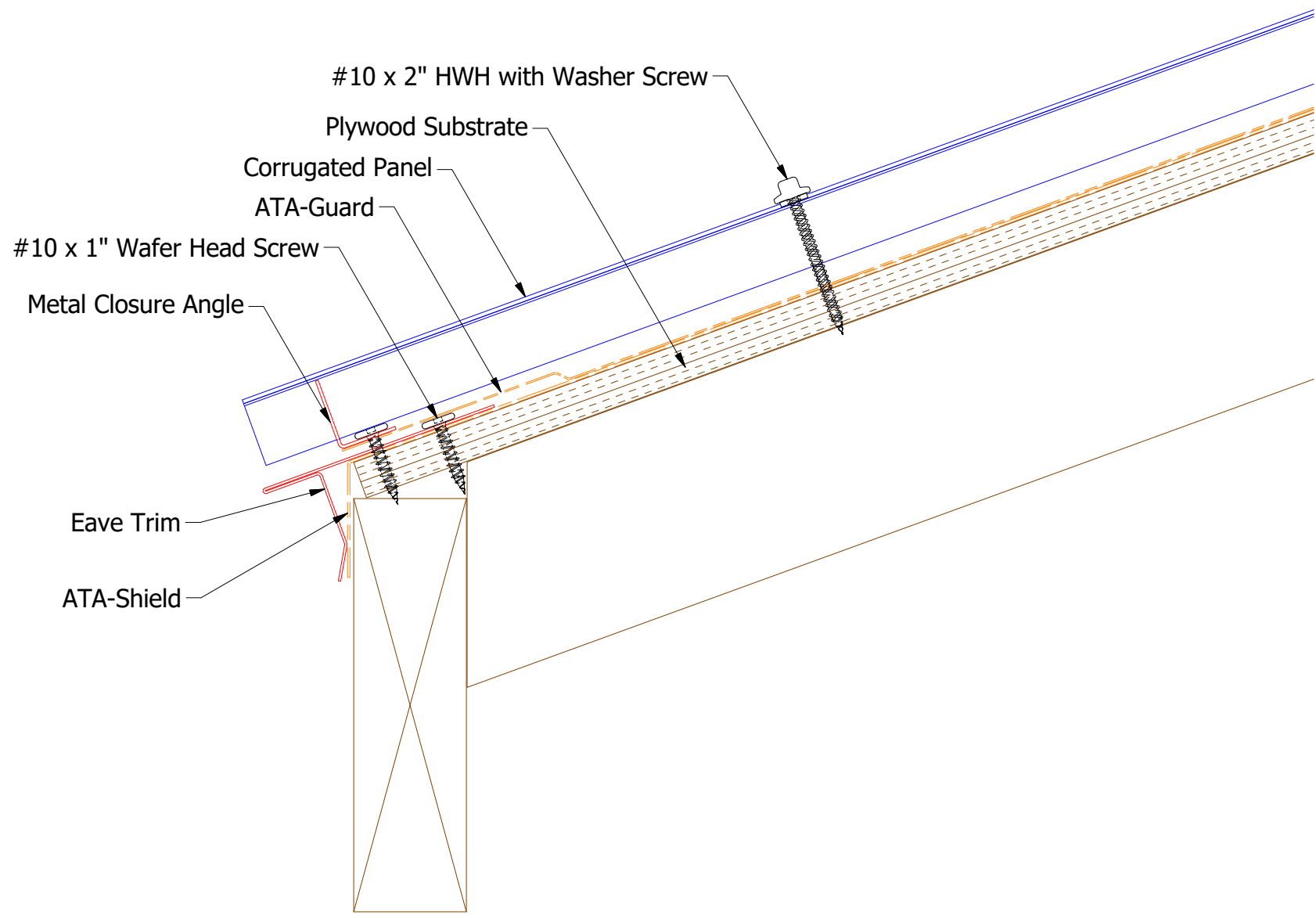

Note: * denotes color side.

Metal Closure Angle

Eave Trim

ATAS ATAS INTERNATIONAL, INC
 Allentown PA
 610-395-8445
 Mesa AZ
 480-558-7210

TITLE				BWC Eave Detail	
DWG. NO.		DR		DATE	
		KRK		11/24/2014	
REV. NO.		APP		DATE	
01		1/13/2022			
DESCRIPTION OF REVISION		BY		SCALE	
Updated Substrate		KRK		B X:X	
		APP			

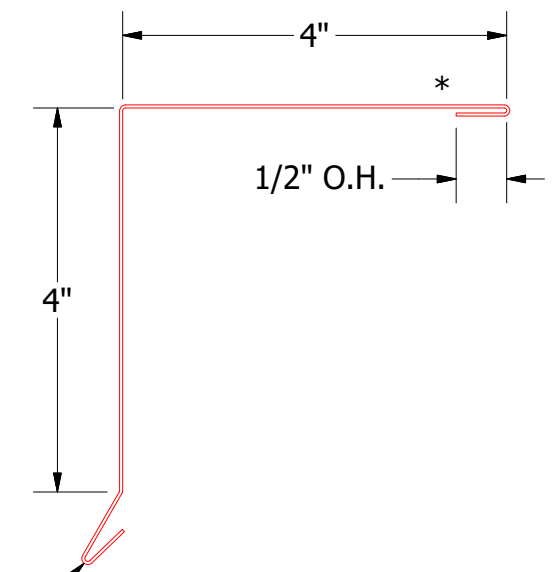
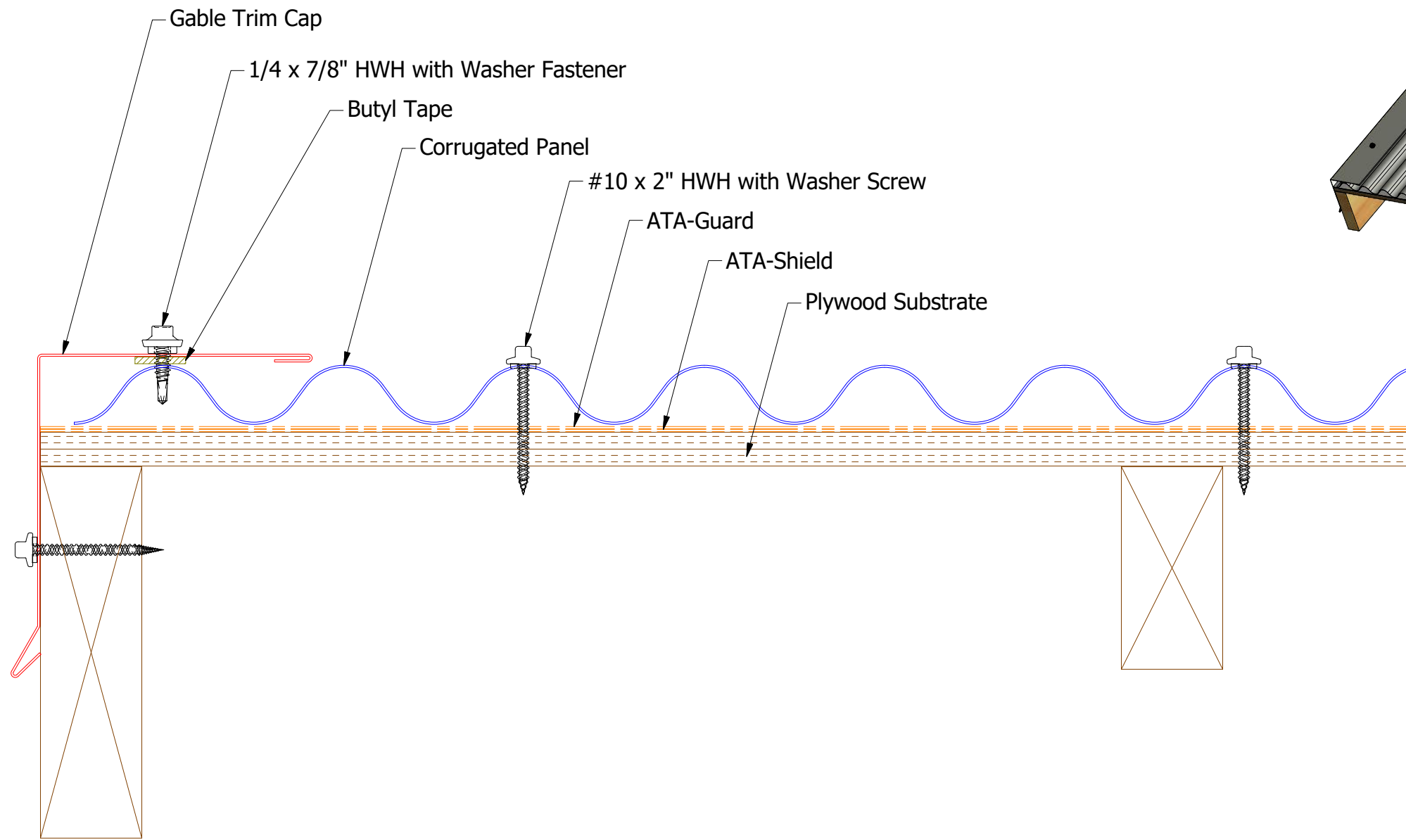

13/16" x 1/2" Hem **Gable Trim Cap**

Note: * denotes color side.

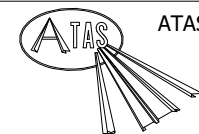

ATAS INTERNATIONAL, INC
 Allentown PA
 610-395-8445
 Mesa AZ
 480-558-7210

				TITLE	
				BWC Curved Gable Detail	
REV. NO.		DATE	DESCRIPTION OF REVISION	BY	APP
01		1/17/2022	Updated Trims	KRK	
				DWG. NO.	DR MBP DATE 7/13/18
				MATERIAL	APP DATE
				SH. SIZE	B SCALE X:X

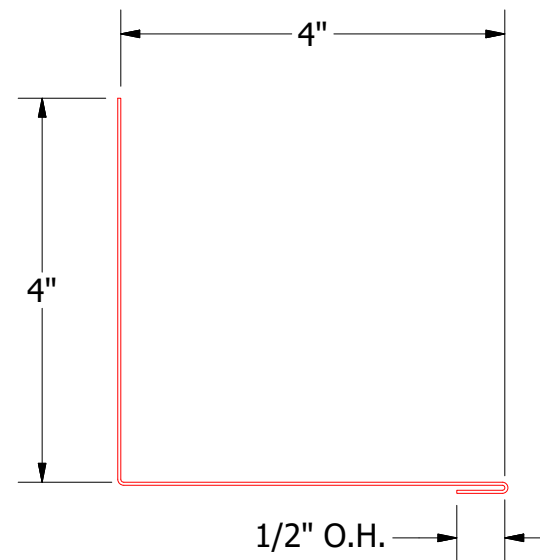
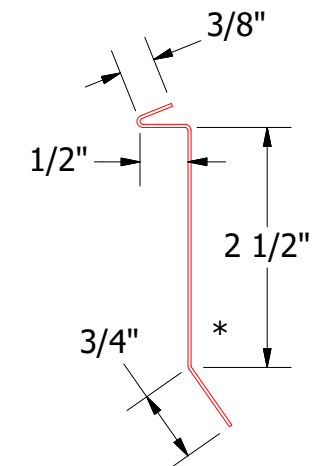
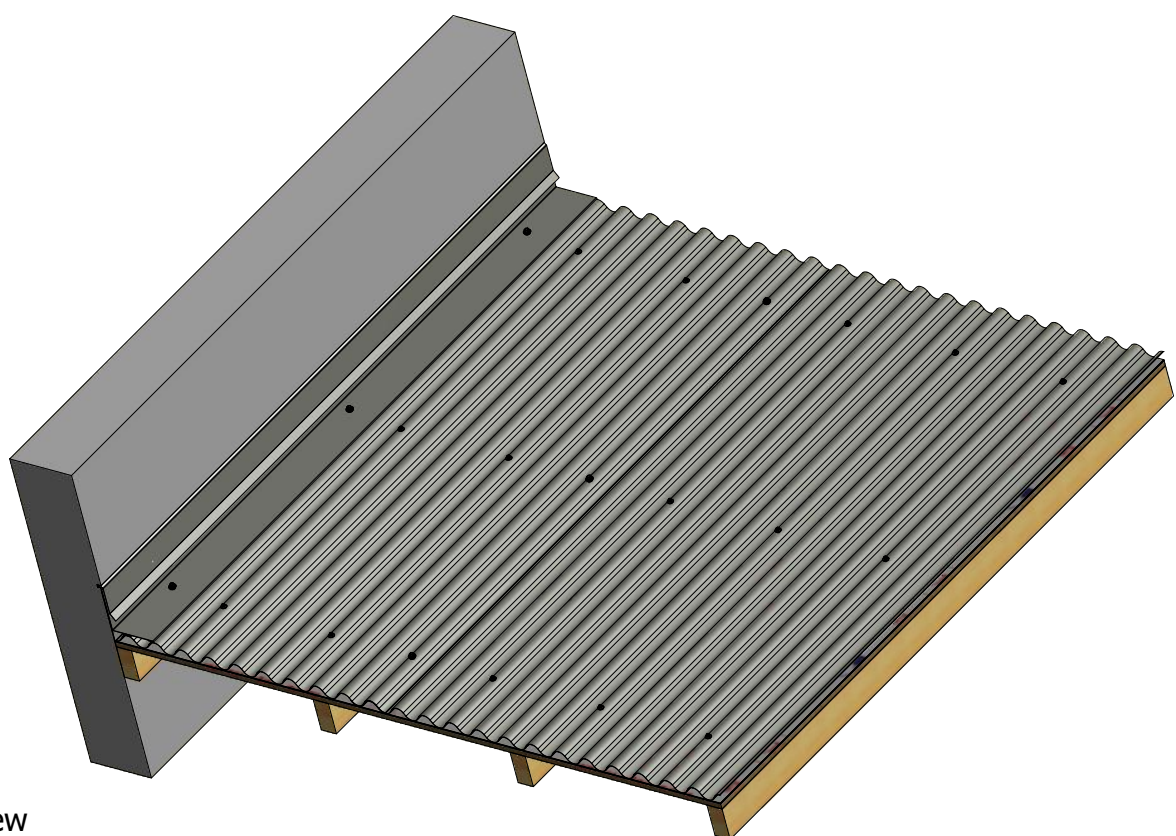
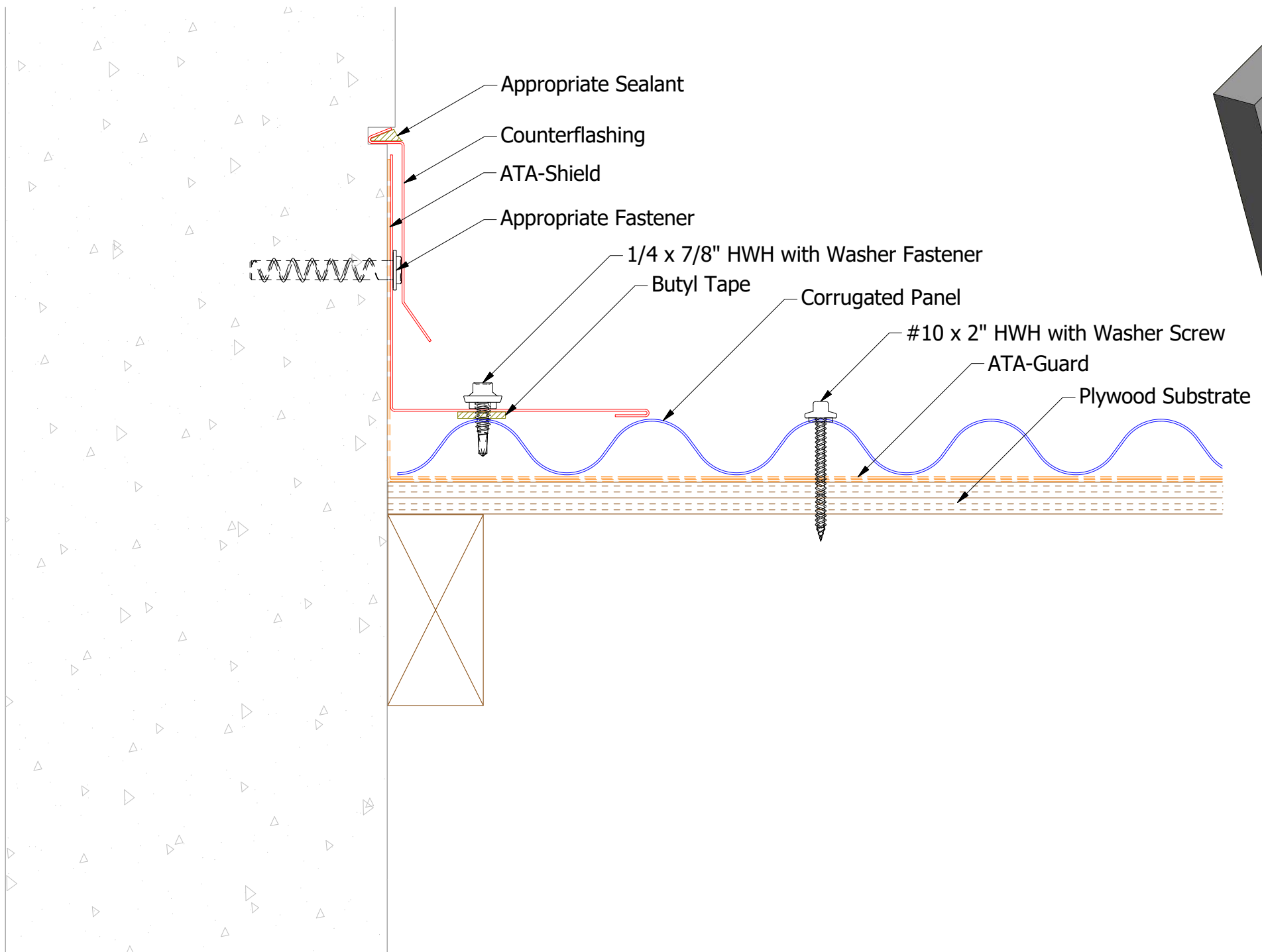

Sidewall Trim

ATAS INTERNATIONAL, INC
 Allentown PA
 610-395-8445
 Mesa AZ
 480-558-7210

BWC Sidewall Detail

01	1/18/2022	Update Substrate and Trims	KRK		DR	KRK
REV. NO.	DATE	DESCRIPTION OF REVISION	BY	APP	DATE	DATE
					SH. SIZE	B
					SCALE	X:X

Note: * denotes color side.

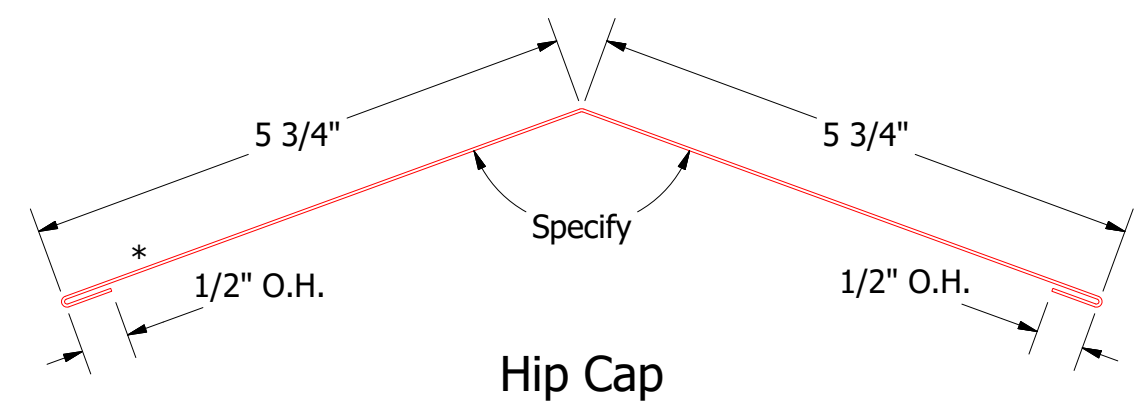
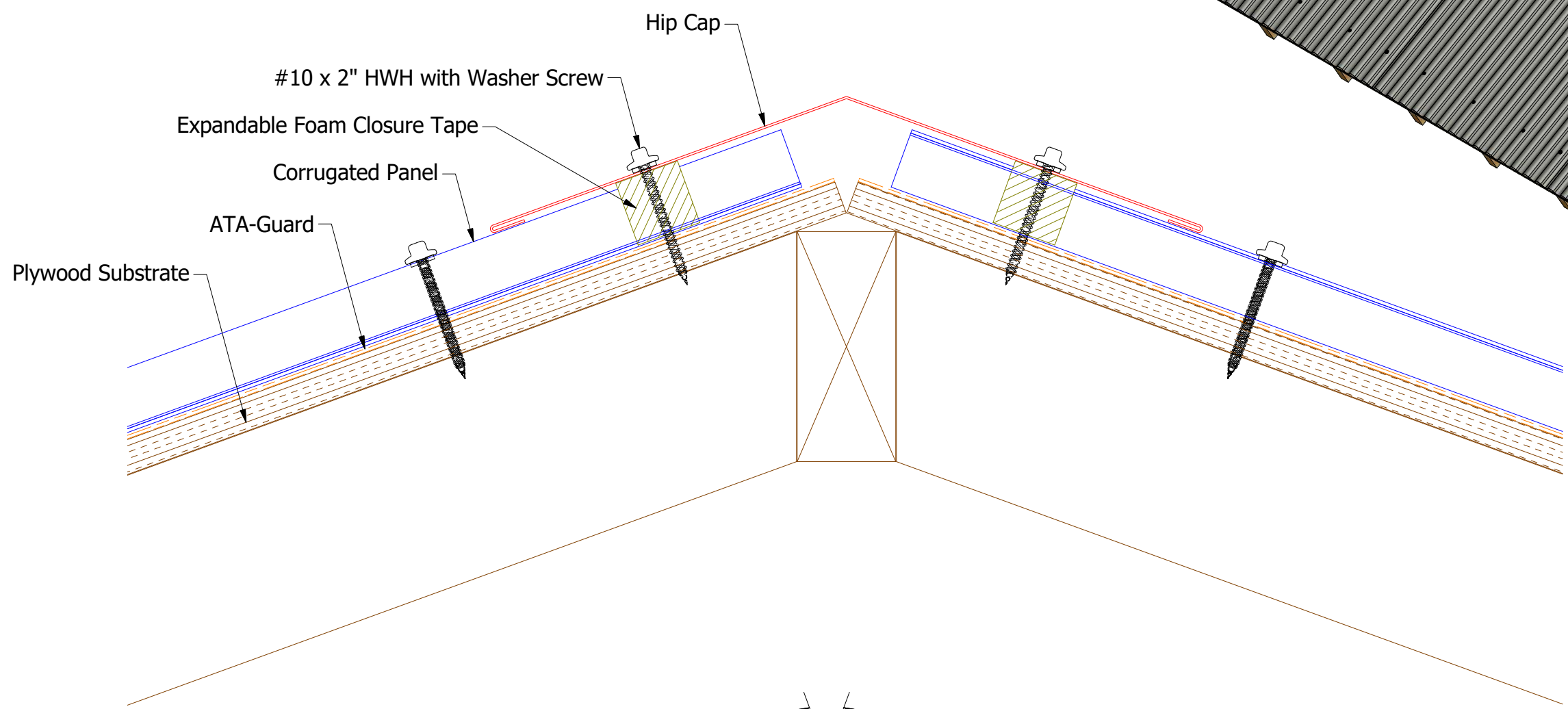
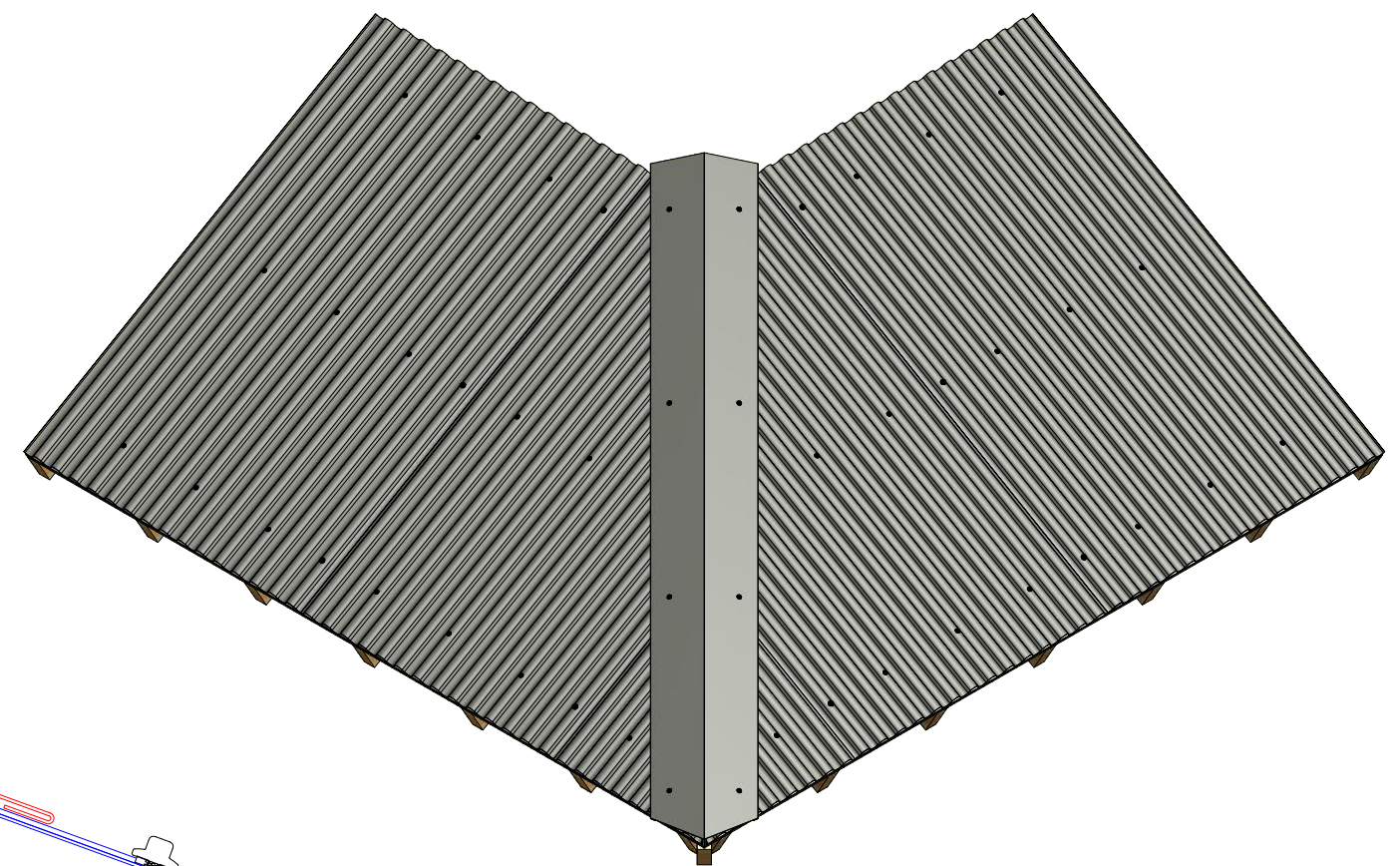

Note: * denotes color side.



ATAS INTERNATIONAL, INC
 Allentown PA
 610-395-8445
 Mesa AZ
 480-558-7210

TITLE				BWC Hip Detail		
DWG. NO.				DR	KRK	DATE
01	1/18/2022	Updated Substrate and Trims	KRK	APP		DATE
REV. NO.	DATE	DESCRIPTION OF REVISION	BY	APP	SH. SIZE	SCALE
					B	X:X

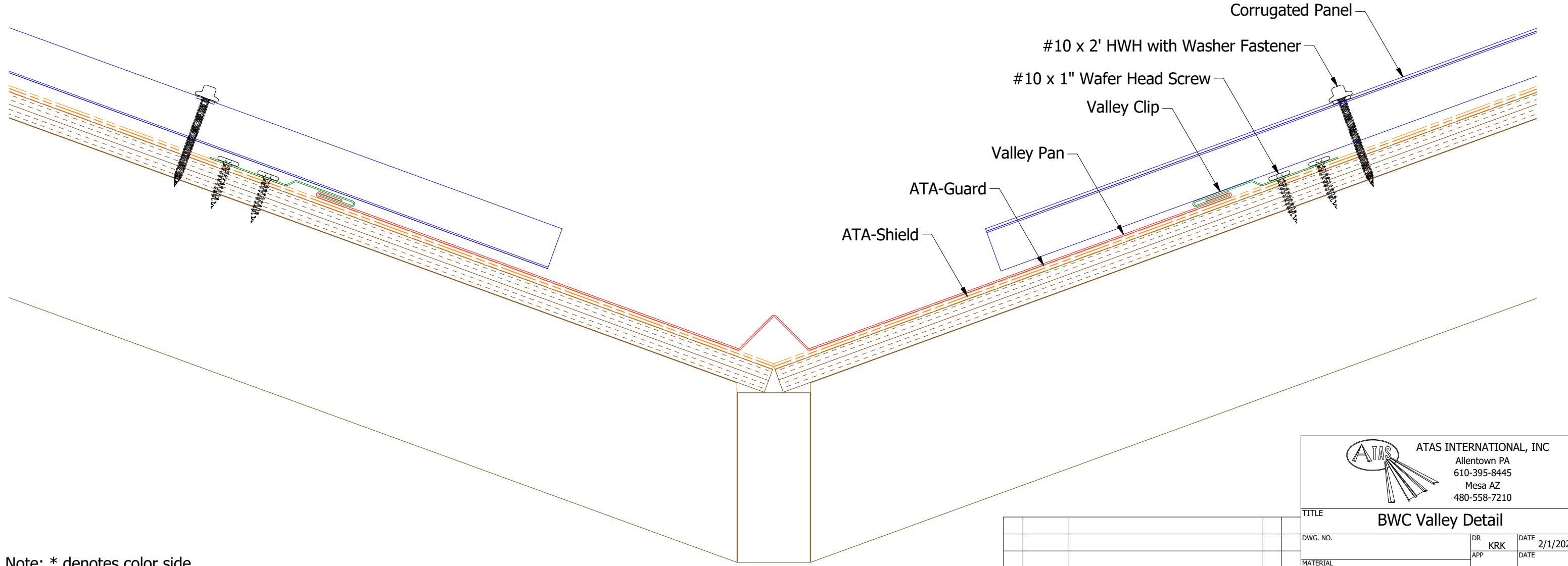
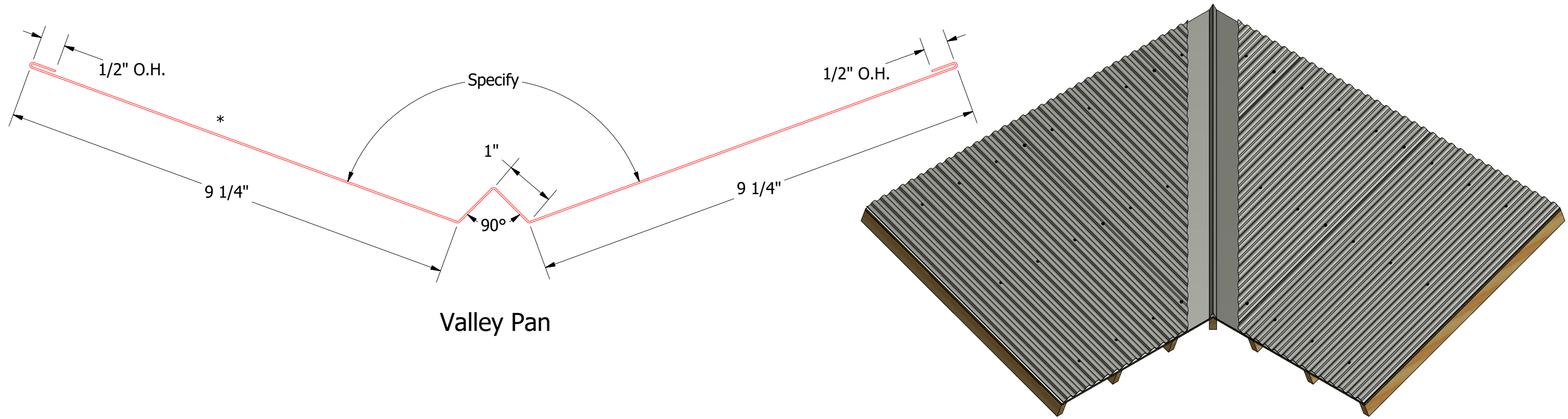

Note: * denotes color side.

ATAS ATAS INTERNATIONAL, INC
 Allentown PA
 610-395-8445
 Mesa AZ
 480-558-7210

TITLE					BWC Valley Detail		
REV. NO.		DATE	DESCRIPTION OF REVISION	BY	APP	DWG. NO.	
						DR	DATE
						KRK	2/1/2022
						APP	DATE
						MATERIAL	
						SH. SIZE	SCALE
						B	X:X

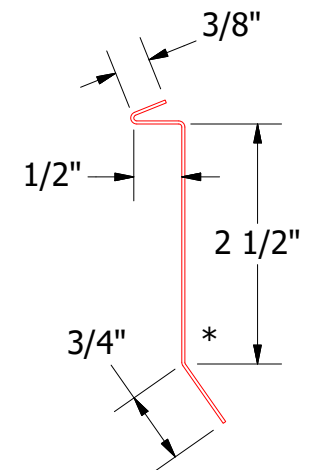
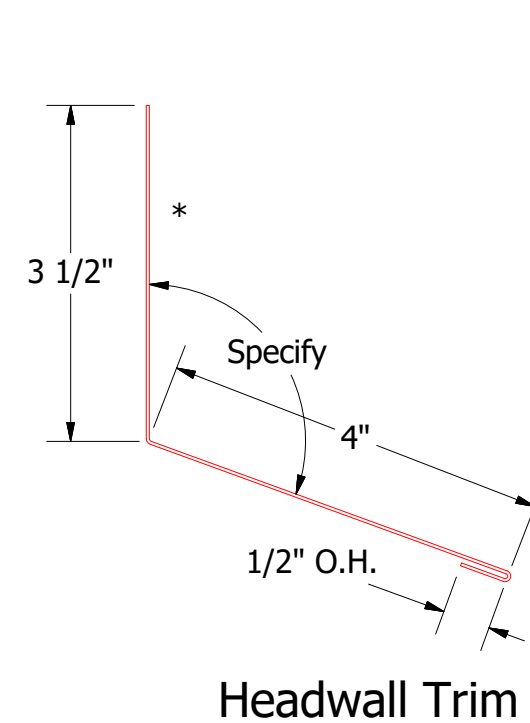
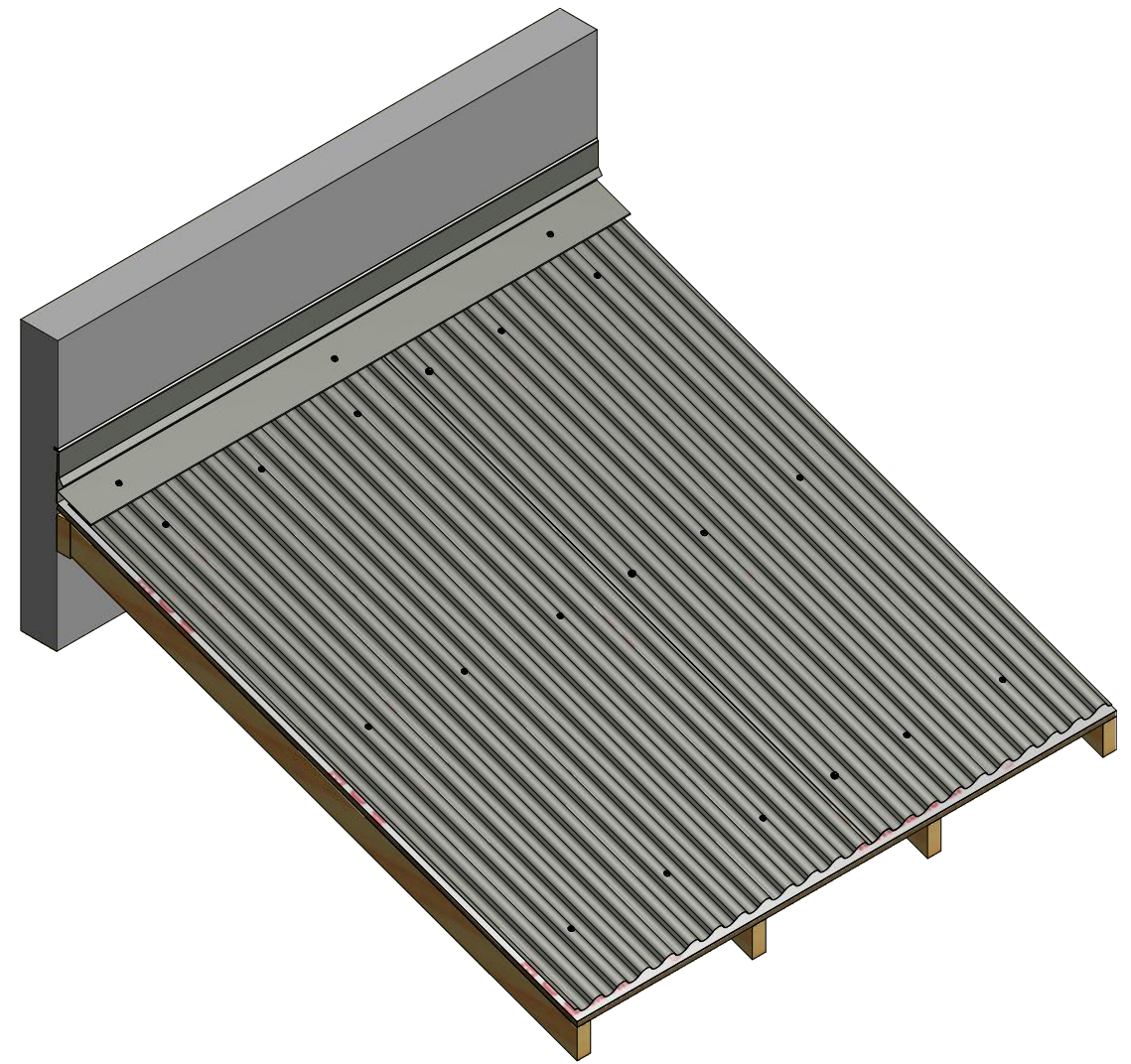
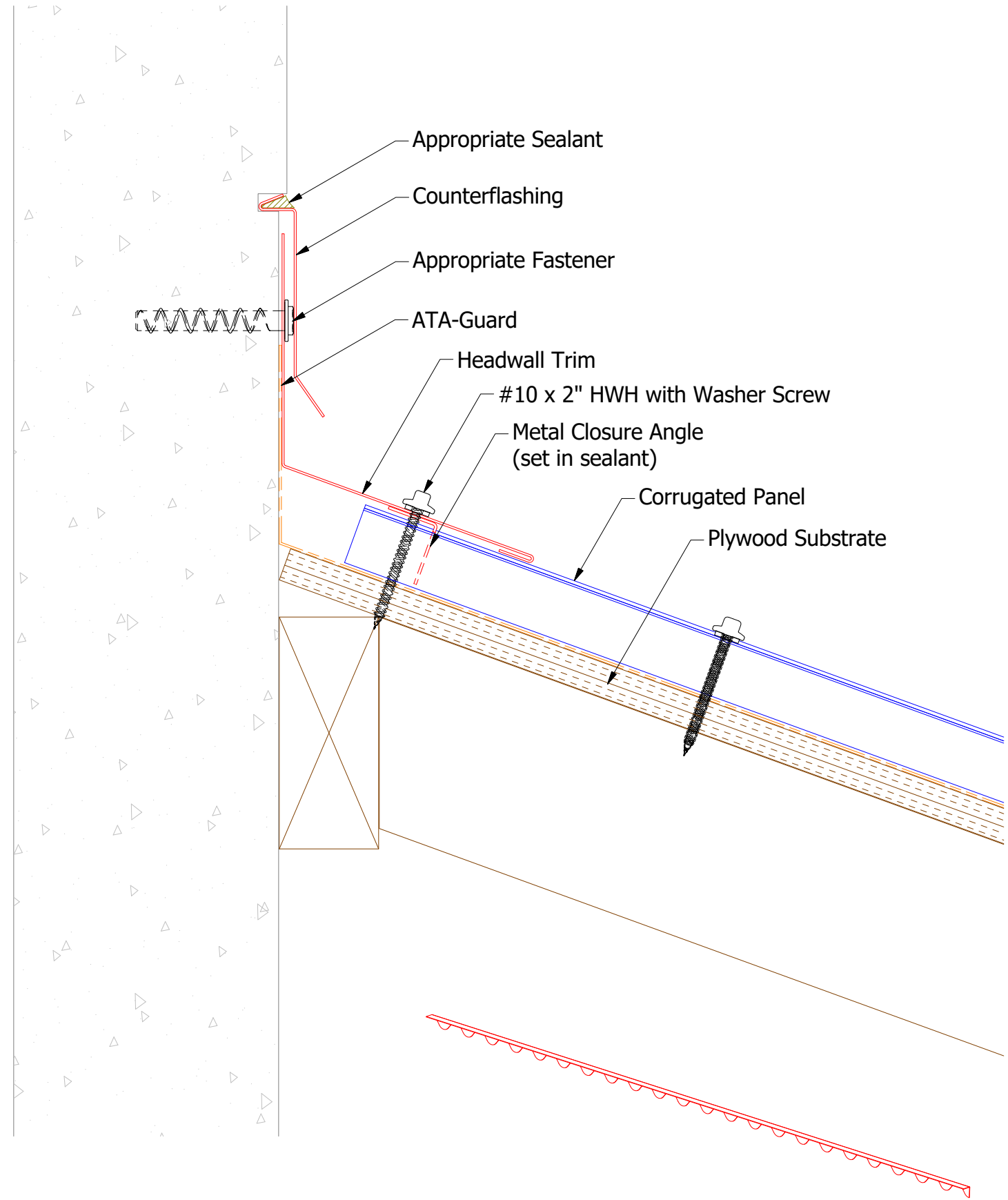

Counterflashing

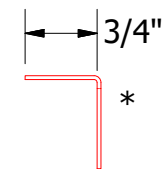

Metal Closure Angle

Note: * denotes color side.

		ATAS INTERNATIONAL, INC Allentown PA 610-395-8445 Mesa AZ 480-558-7210	
TITLE			
BWC Headwall Detail			
DWG. NO.	DR	KRK	DATE
	APP		11/24/2014
MATERIAL		SH. SIZE	SCALE
		B	X:X

REV. NO.	DATE	DESCRIPTION OF REVISION	BY	APP

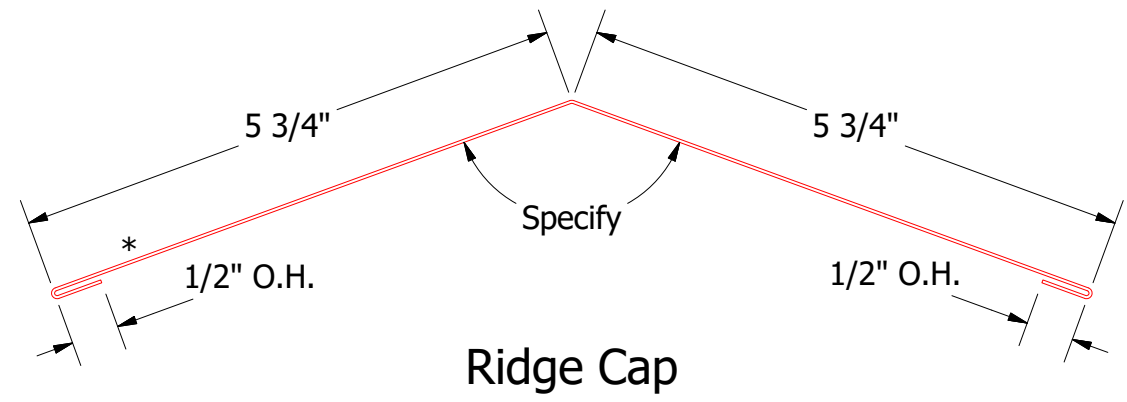
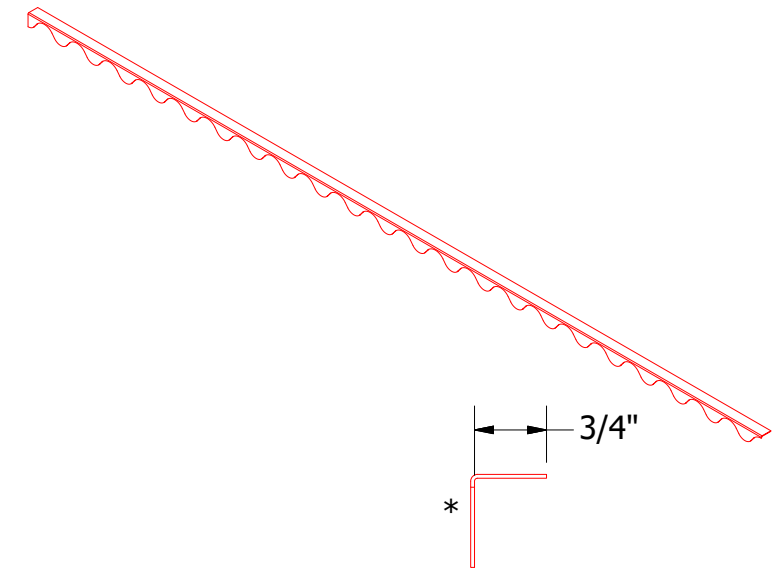
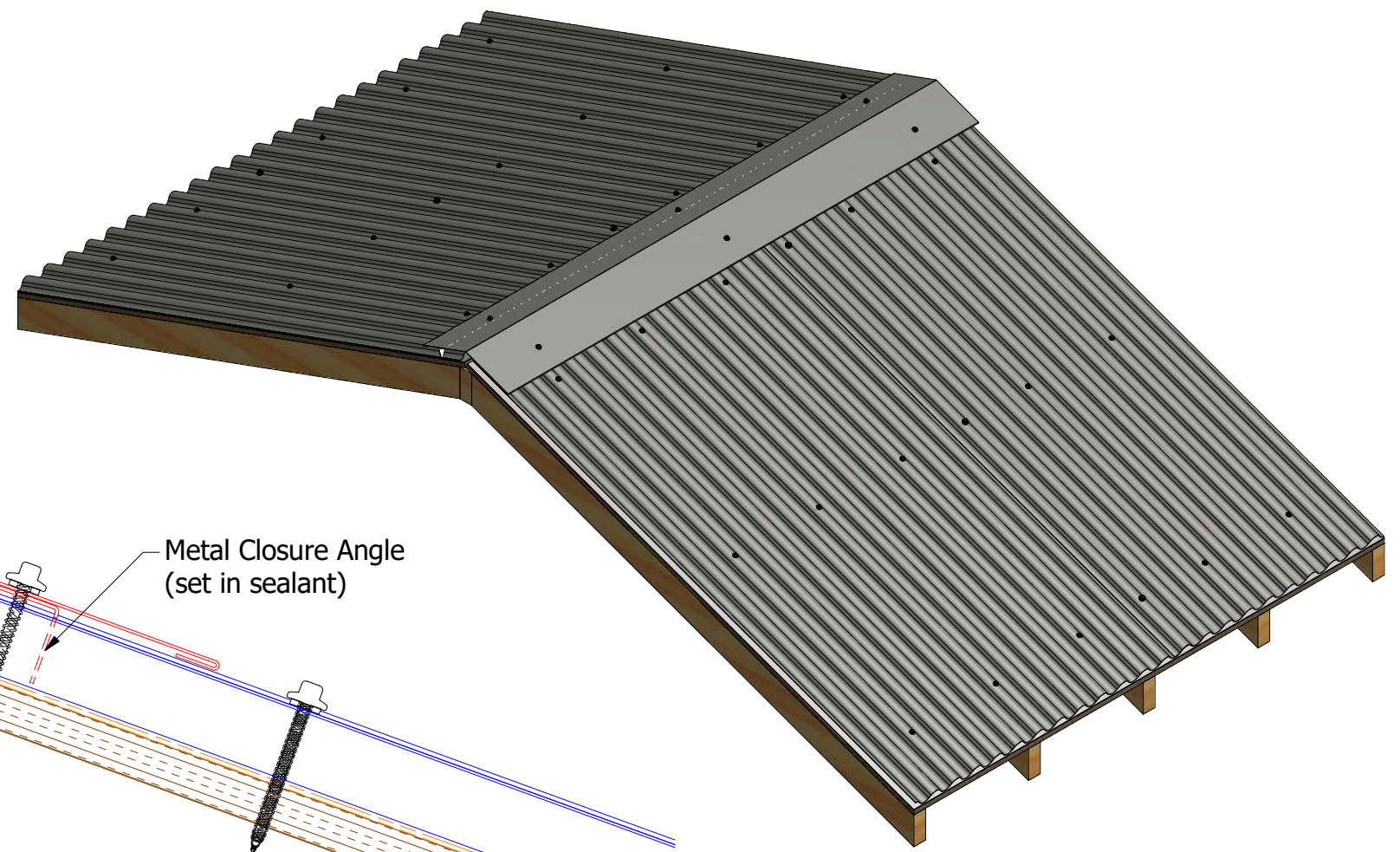
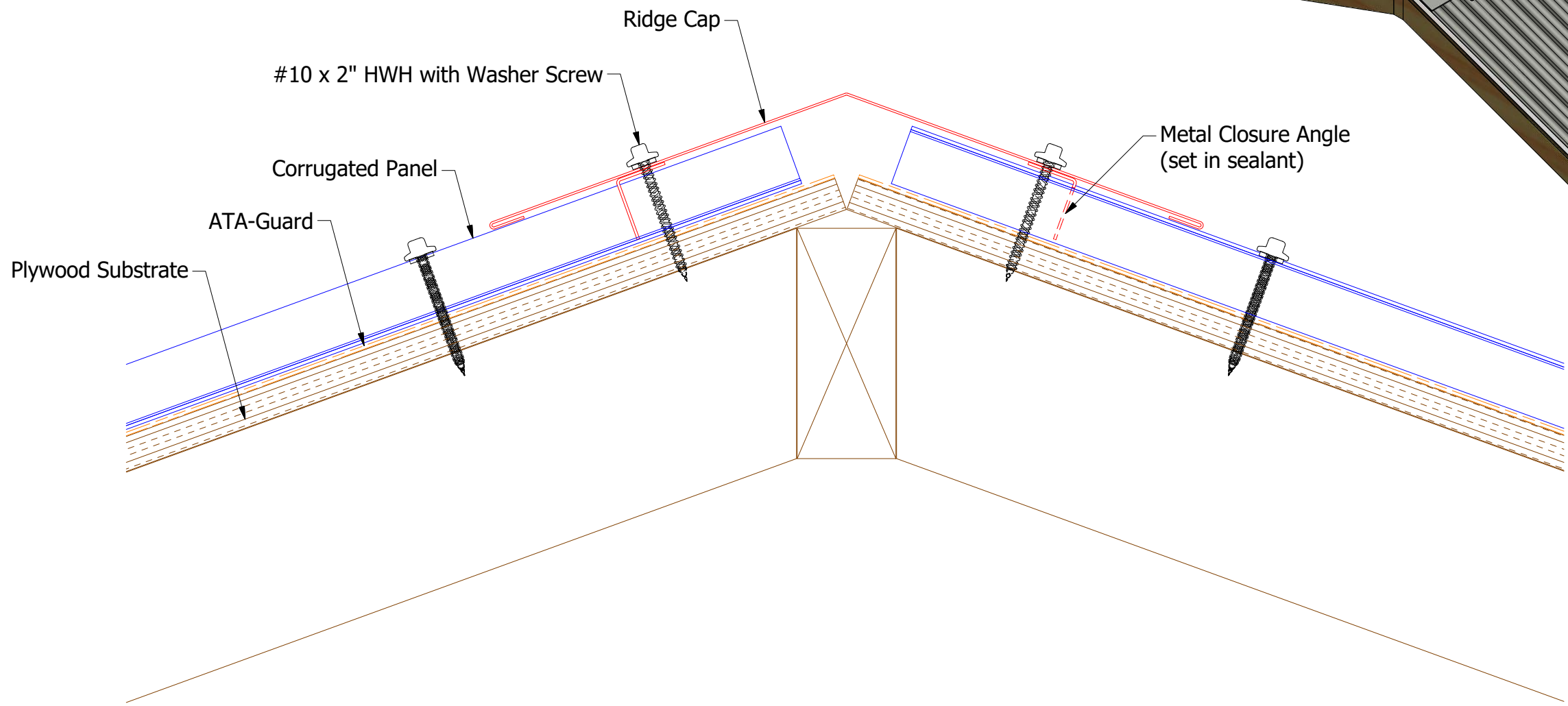

Note: * denotes color side.

Metal Closure Angle

ATAS INTERNATIONAL, INC
 Allentown PA
 610-395-8445
 Mesa AZ
 480-558-7210

REV. NO.		DATE	DESCRIPTION OF REVISION	BY	APP	TITLE	
						BWC Ridge Detail	
DWG. NO.		DR	KRK	DATE	1/18/2022		
		APP		DATE			
MATERIAL		SH. SIZE	B	SCALE	X:X		

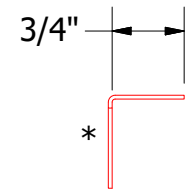
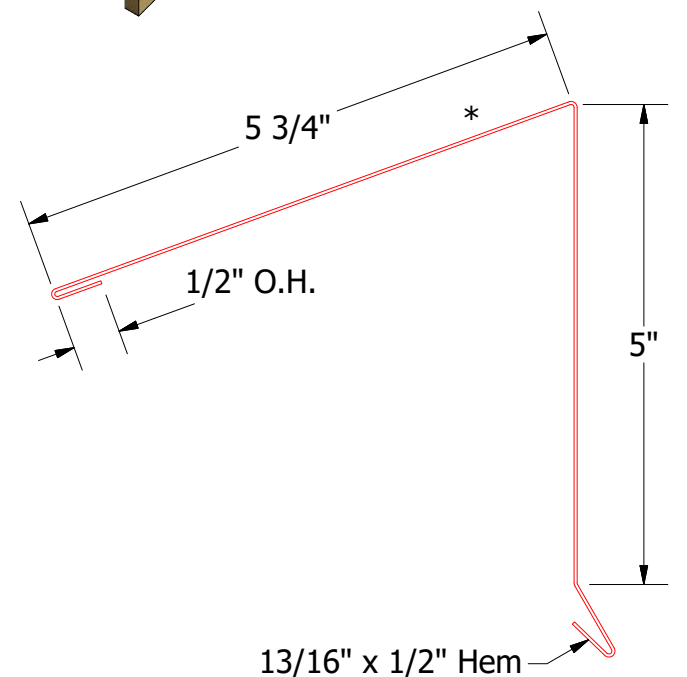
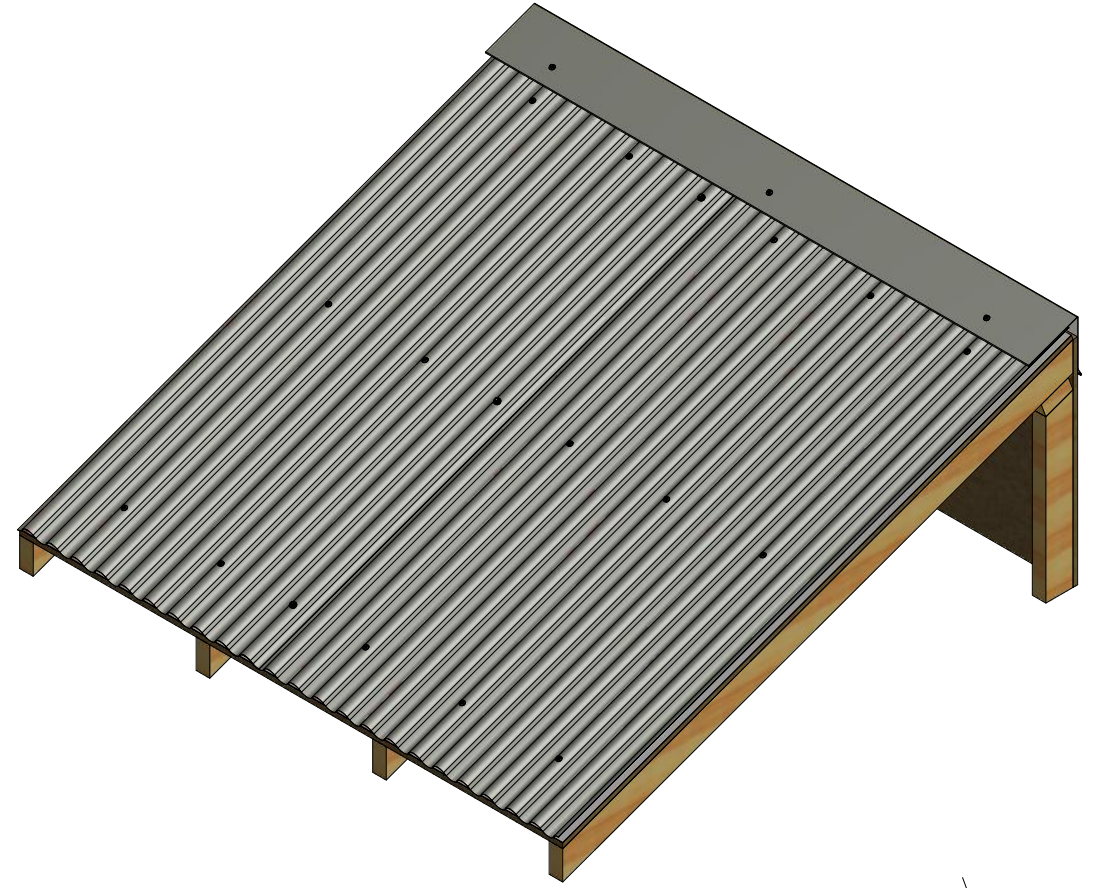
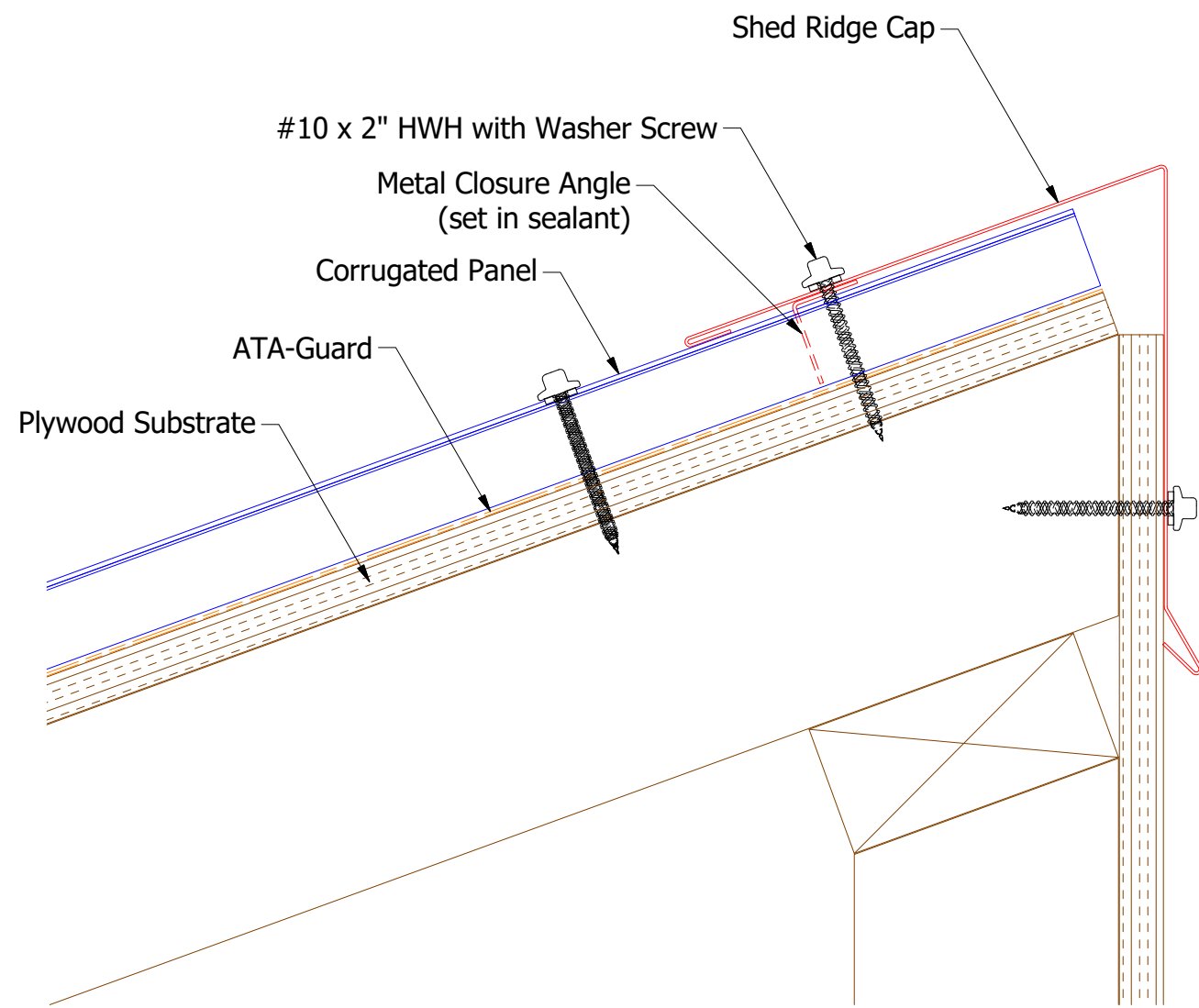

Shed Ridge Cap

Metal Closure Angle

ATAS ATAS INTERNATIONAL, INC
 Allentown PA
 610-395-8445
 Mesa AZ
 480-558-7210

TITLE				BWC Shed Ridge Detail	
DWG. NO.	DR	DATE	APP	DATE	
01	KRK	1/14/2016	APP	DATE	
REV. NO.	DATE	DESCRIPTION OF REVISION	BY	APP	SCALE
		Updated Substrate and Trims	KRK	APP	B X:X

REV. NO.	DATE	DESCRIPTION OF REVISION	BY	APP
01	1/19/2022	Updated Substrate and Trims	KRK	APP

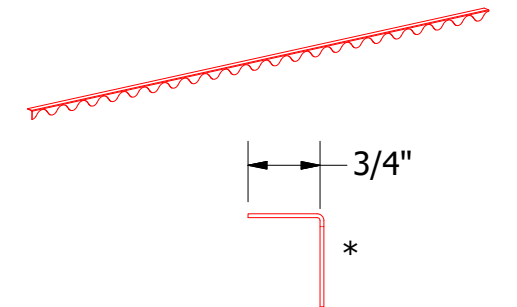
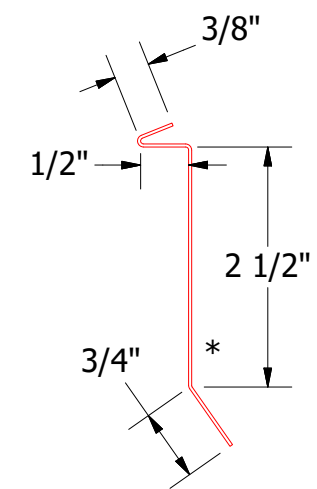
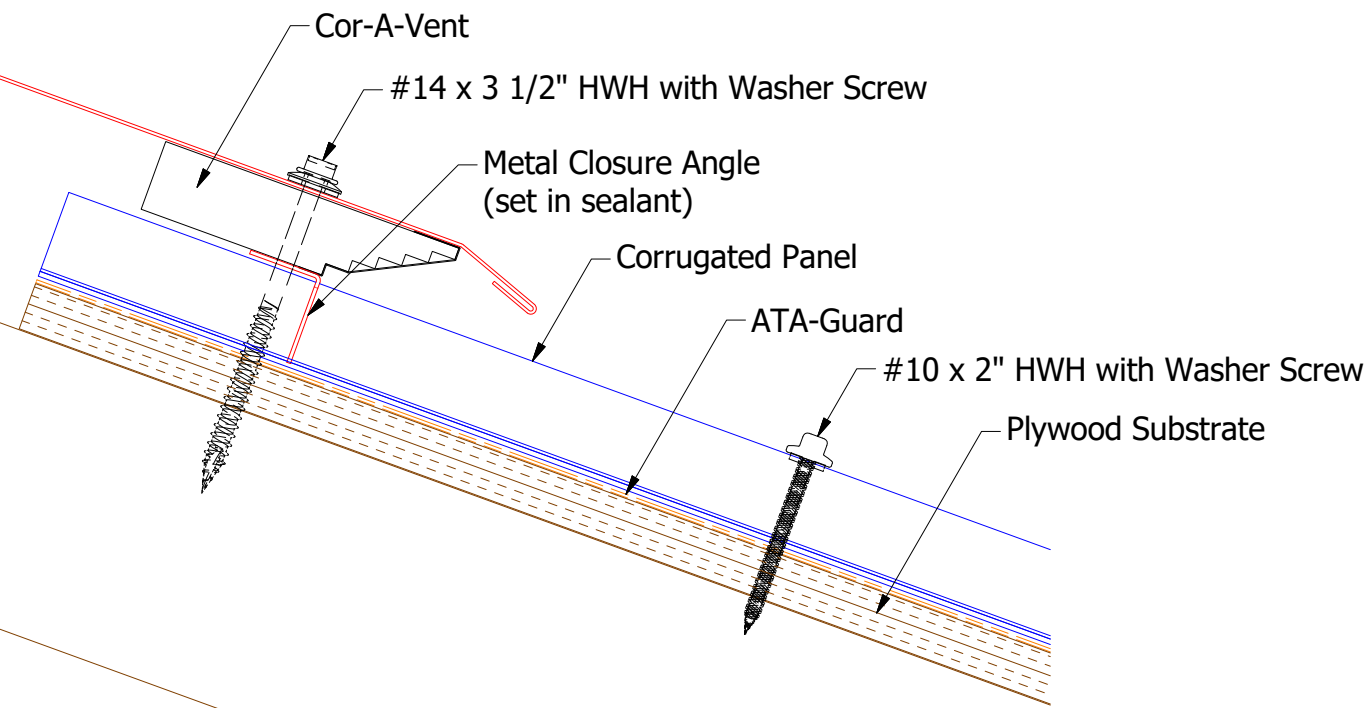
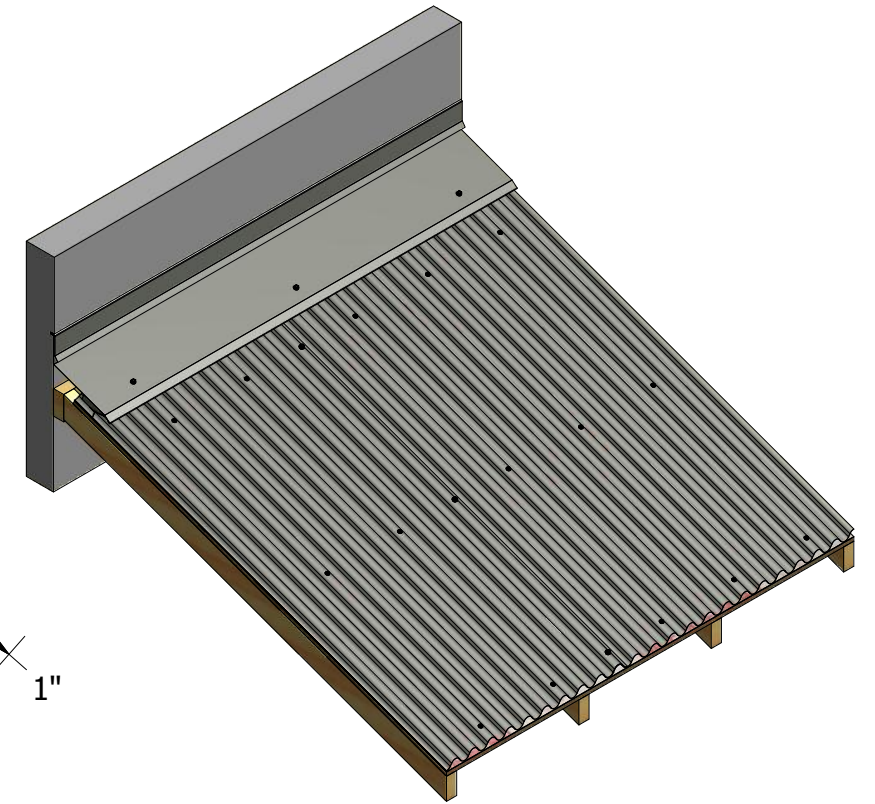
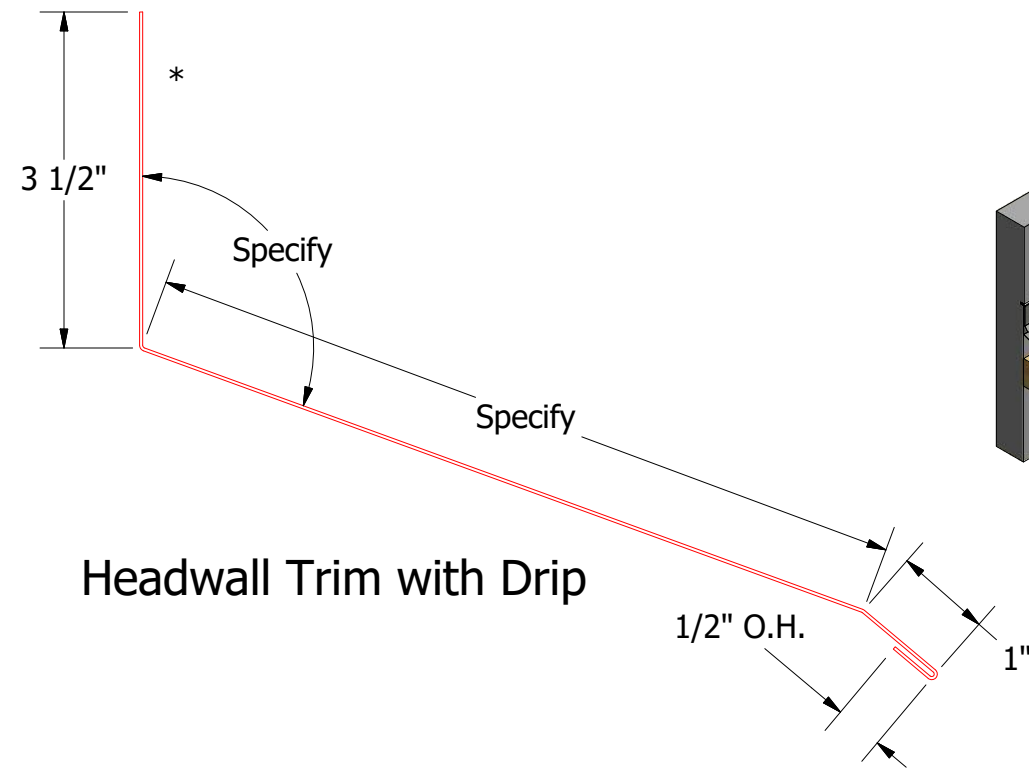
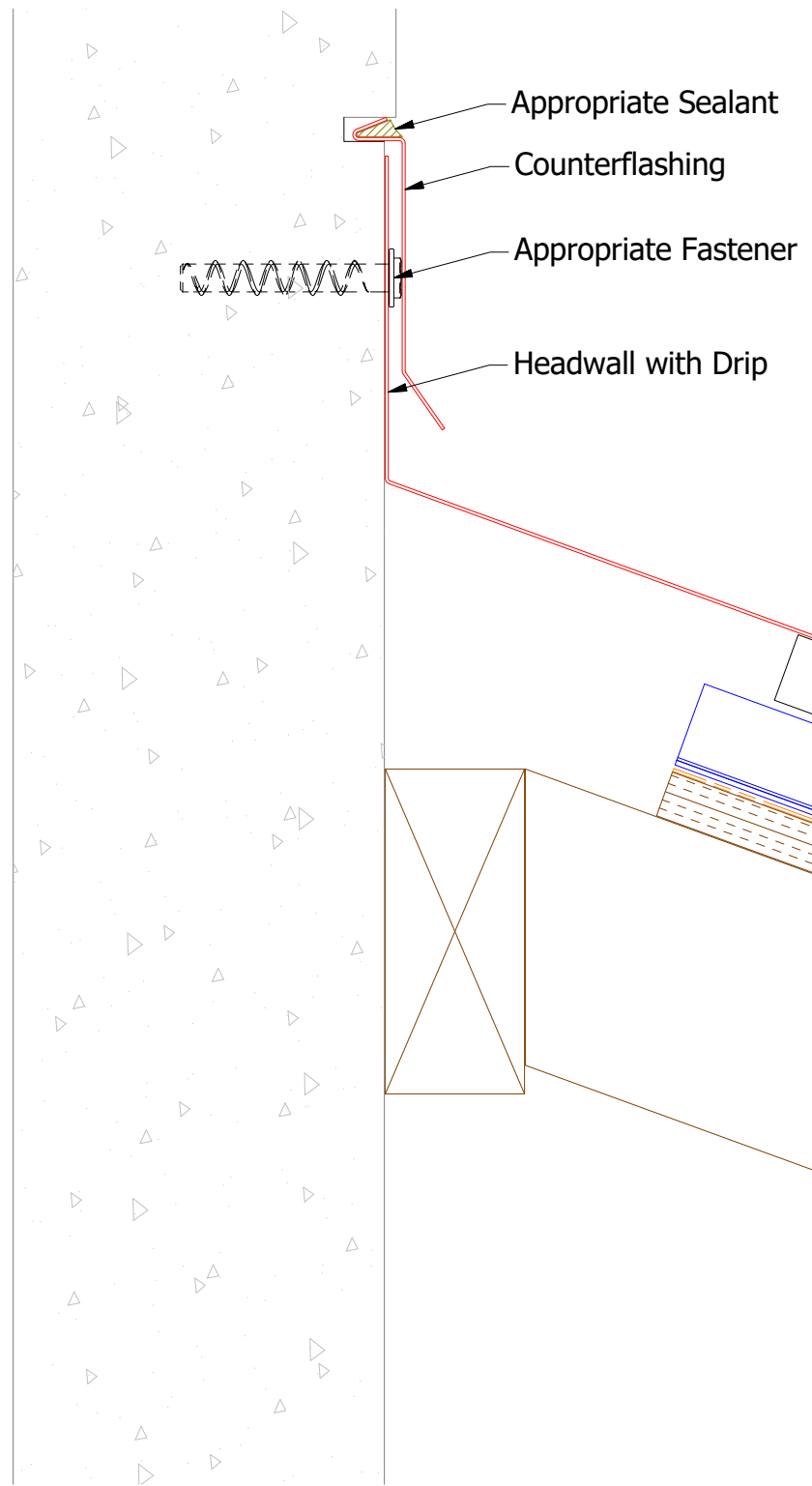

Note: * denotes color side.

REV. NO.		DATE	DESCRIPTION OF REVISION	BY	APP	TITLE	
						BWC Vented Headwall Detail	
DWG. NO.		DR	KRK	DATE	1/19/2022		
		APP		DATE			
MATERIAL		SH. SIZE	B	SCALE	X:X		

ATAS
ATAS INTERNATIONAL, INC
Allentown PA
610-395-8445
Mesa AZ
480-558-7210

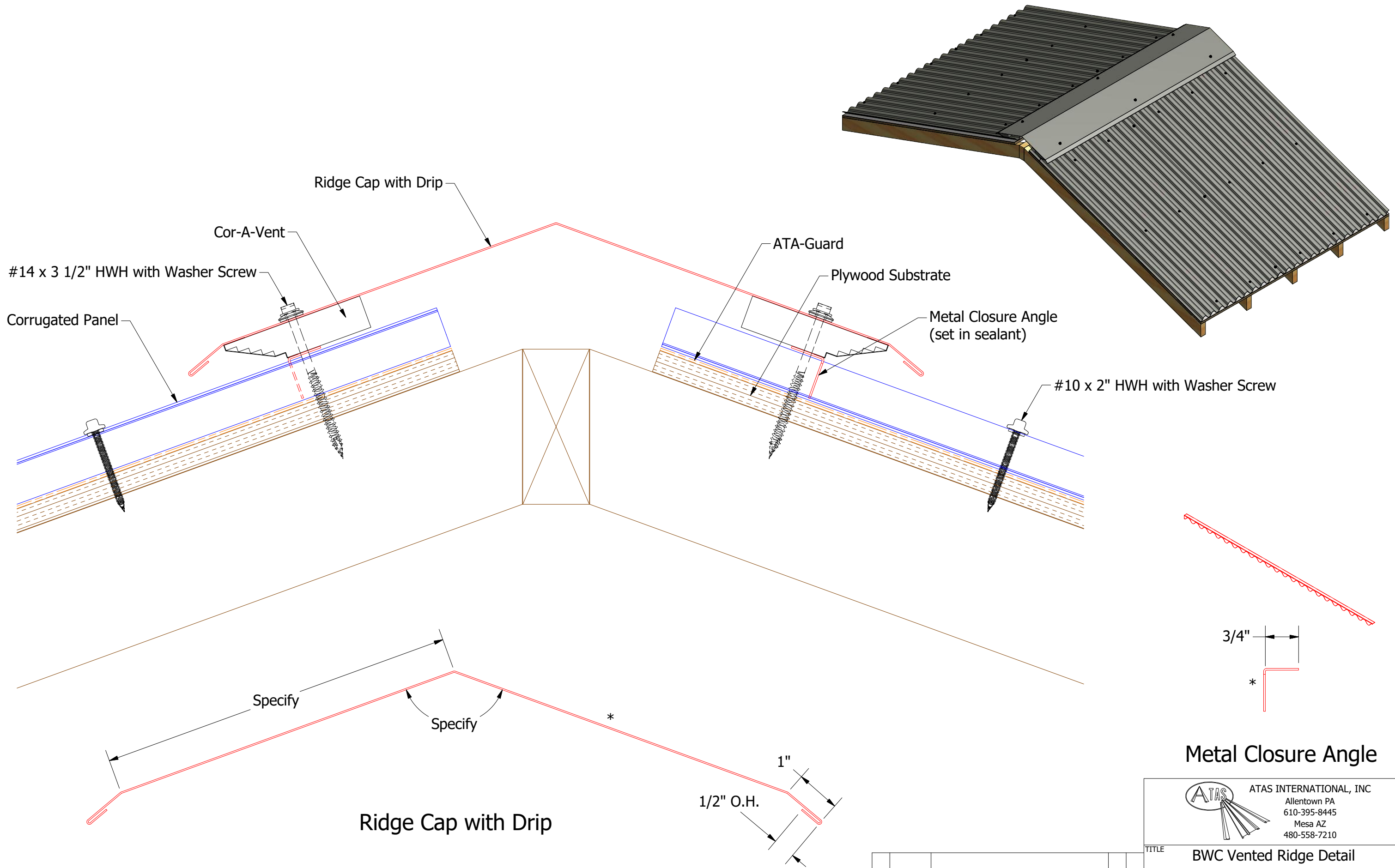

Note: * denotes color side.

				TITLE		BWC Vented Ridge Detail	
REV. NO.				DWG. NO.		DR	
DATE						KRK	
DESCRIPTION OF REVISION				BY		DATE	
1/19/2022				KRK		2/9/2015	
Updated Substrate and Trims				APP		DATE	
				SH. SIZE		SCALE	
				B		X:X	

ATAS ATAS INTERNATIONAL, INC
 Allentown PA
 610-395-8445
 Mesa AZ
 480-558-7210

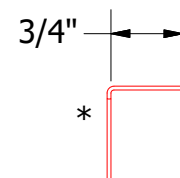
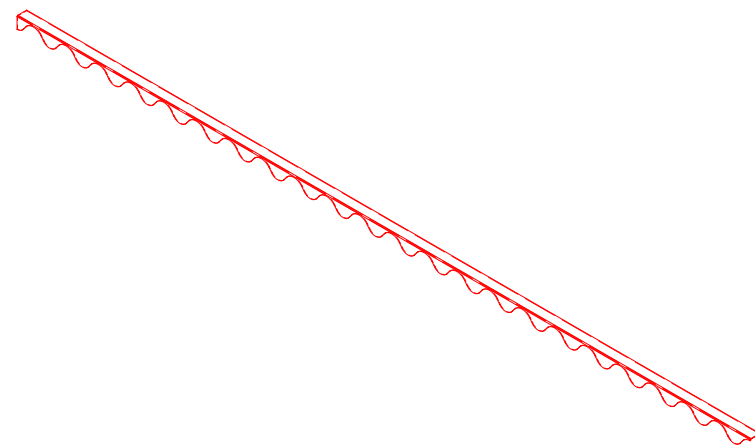
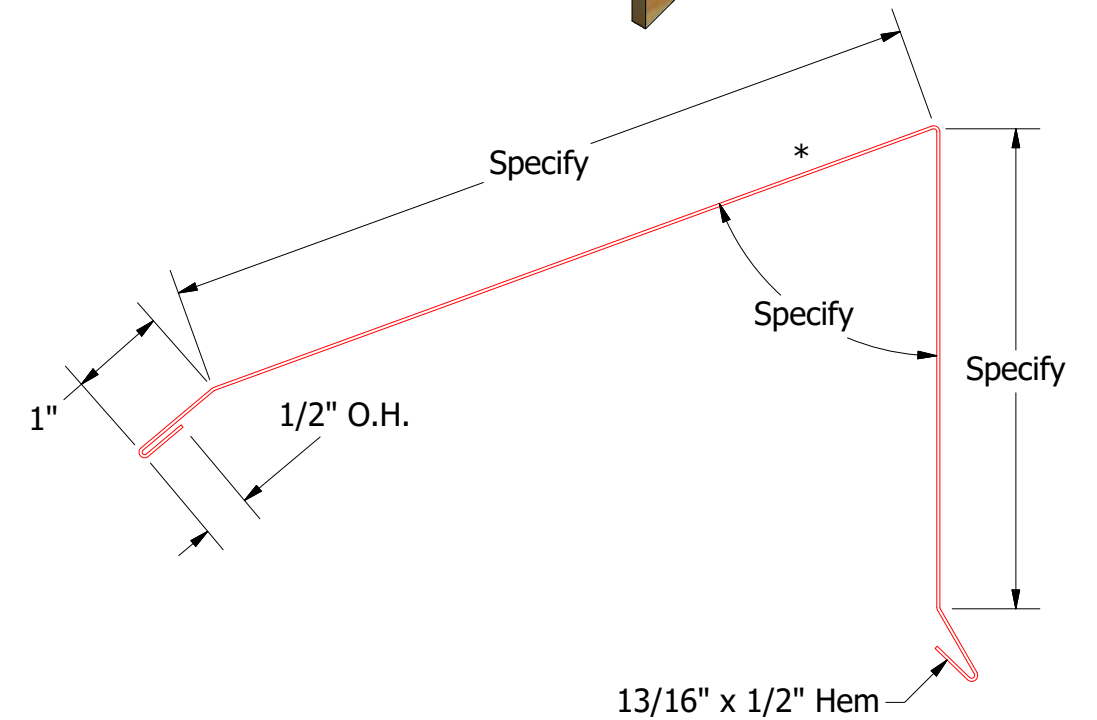
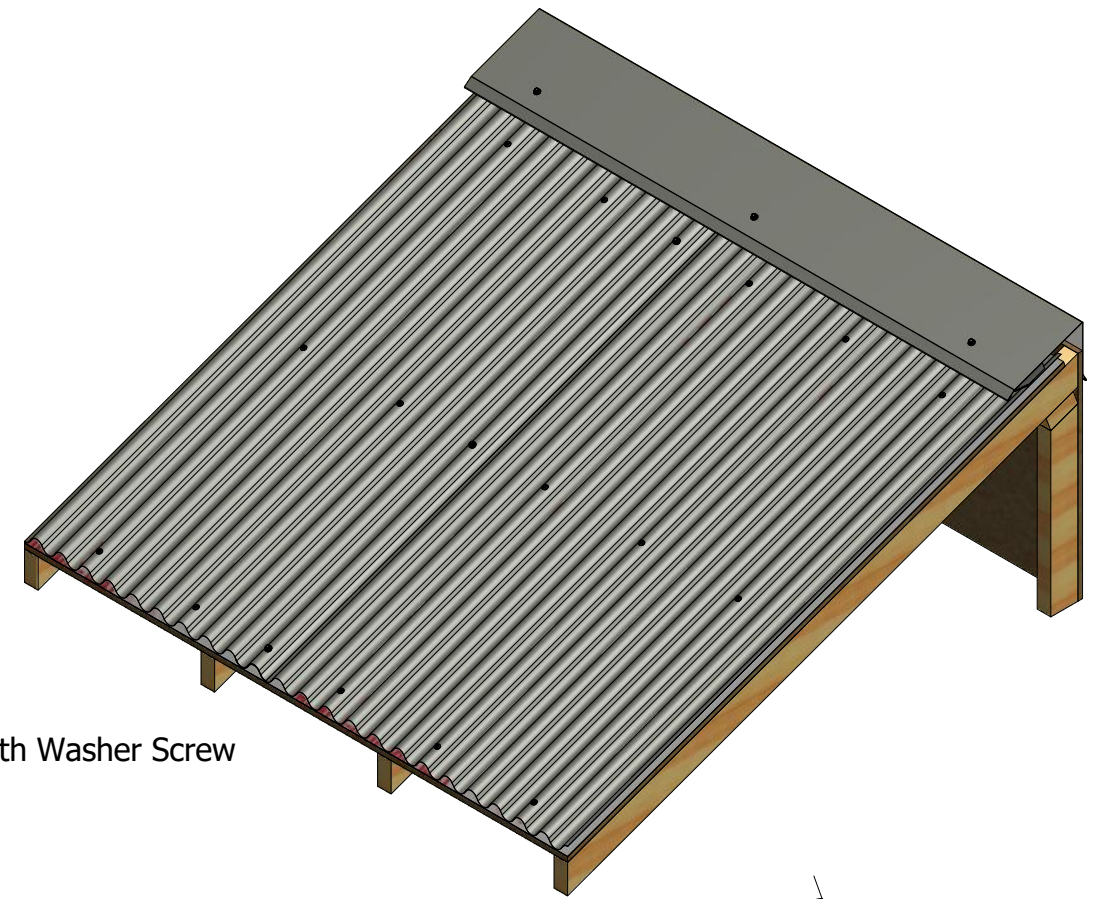
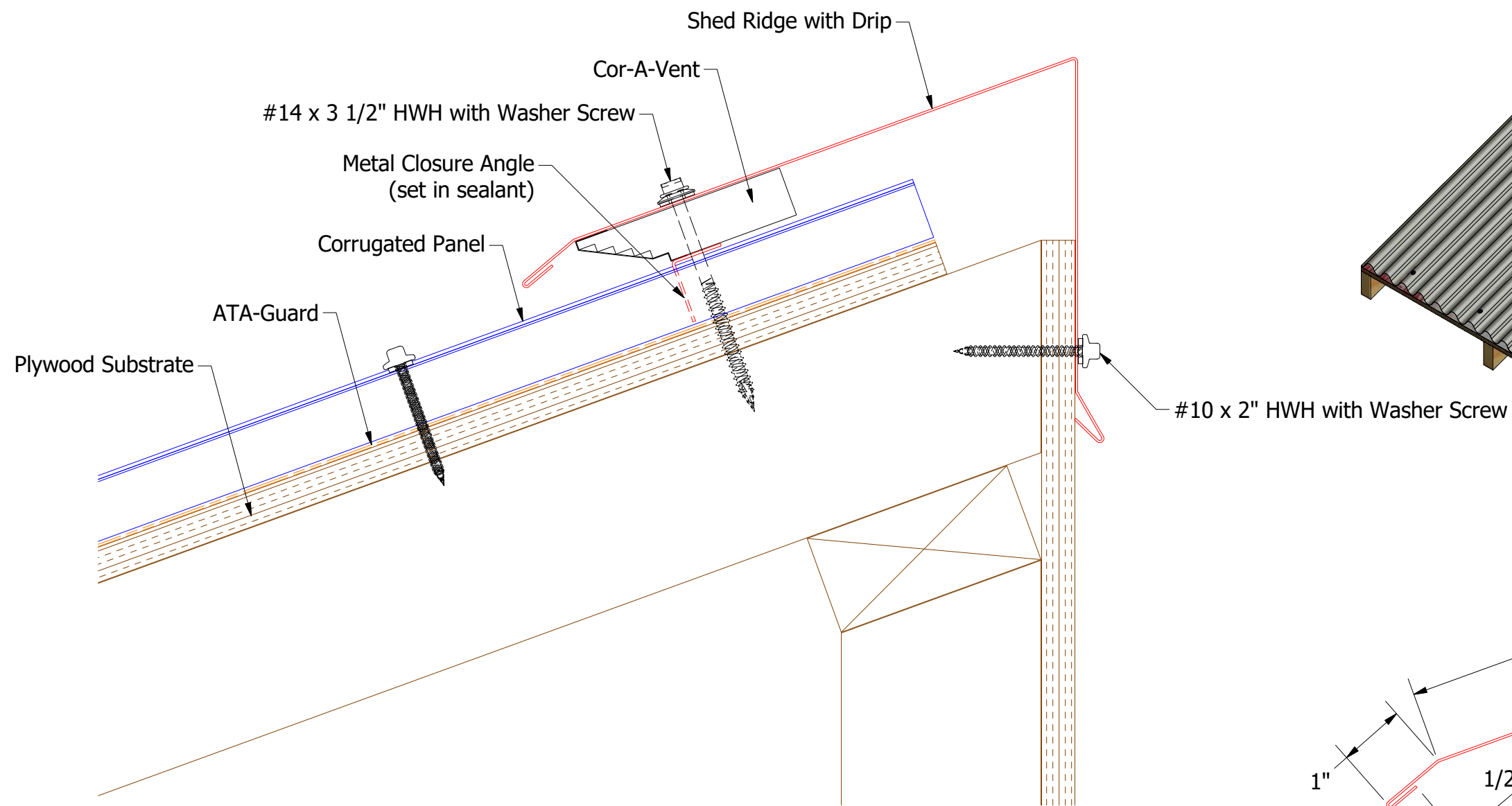

Metal Closure Angle

Shed Ridge with Drip

Note: * denotes color side.

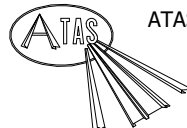
 ATAS INTERNATIONAL, INC Allentown PA 610-395-8445 Mesa AZ 480-558-7210		TITLE	
		BWC Vented Shed Ridge Detail	
DWG. NO.	DR	DATE	
	KRK	1/19/2022	
MATERIAL	APP	DATE	
REV. NO.	DATE	DESCRIPTION OF REVISION	BY APP
	SH. SIZE	B	SCALE X:X