

Vertical Versa-Lok Panel
(standard right-to-left panel)

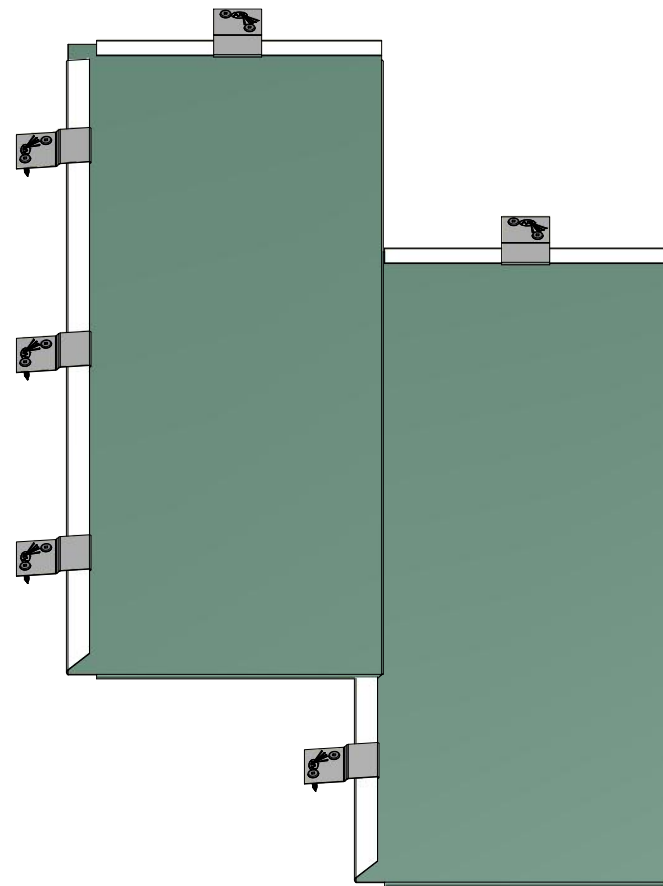

Vertical Installation

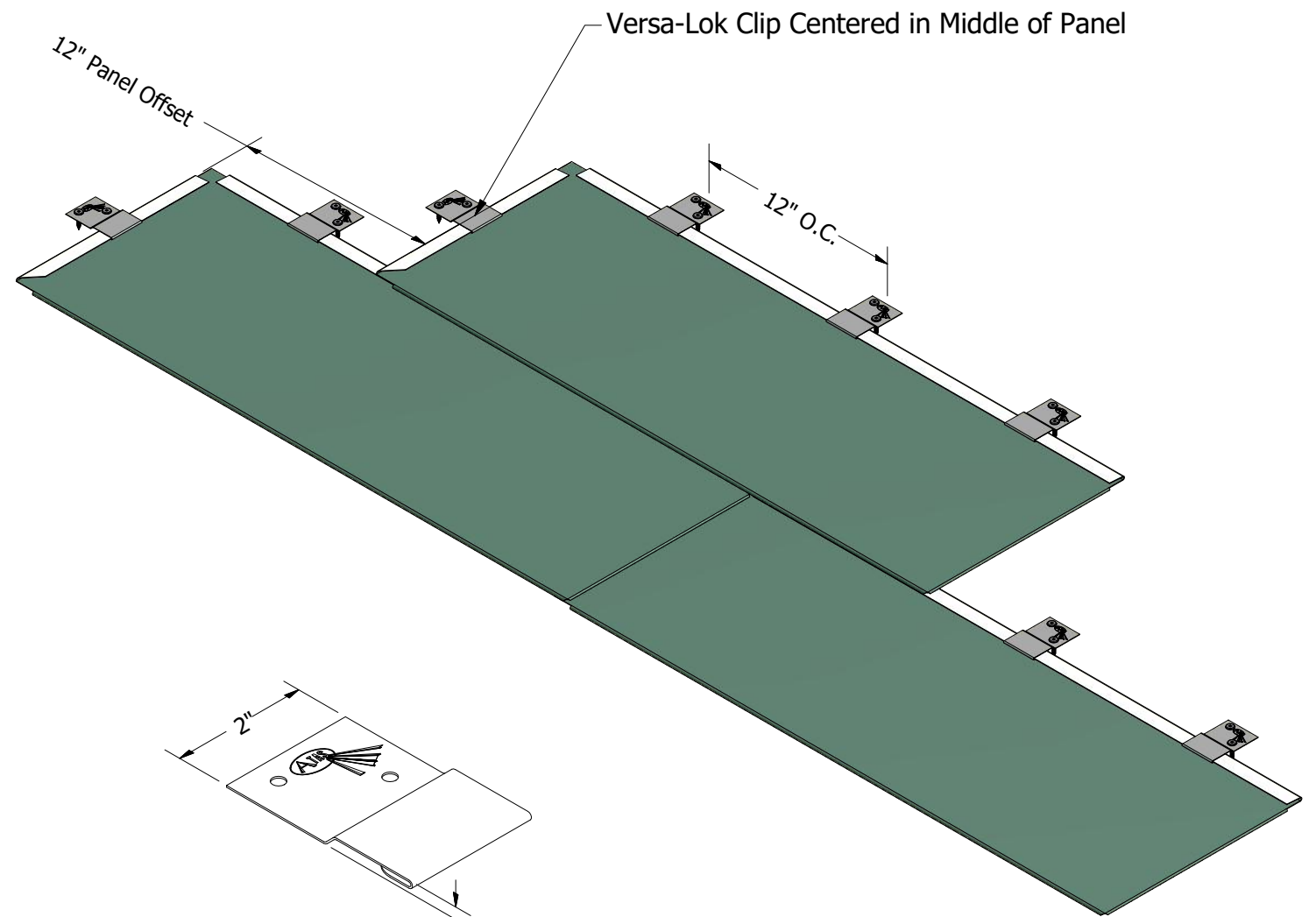

Horizontal Installation

Standard Clip Materials:
0.027" Painted Metallic Coated Steel
24 Gauge Grade 304 Stainless Steel

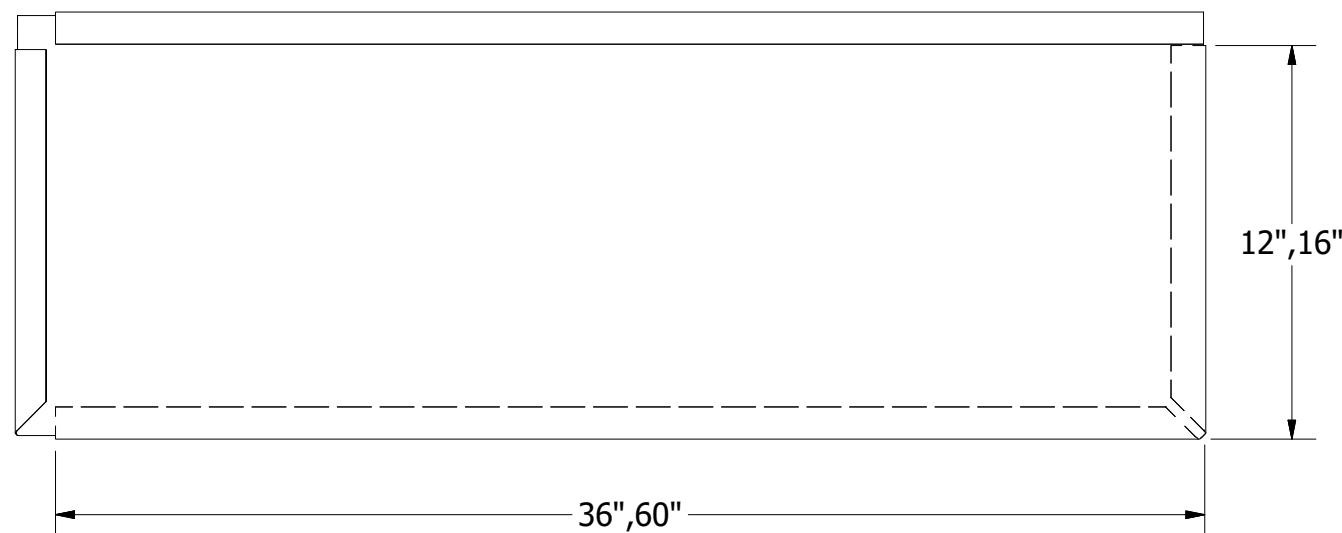

Horizontal Versa-Lok Panel
(standard right-to-left panel)

01		3/9/2021	Updated Panel Notching	KRK	DR		KRK	DATE	2/9/2016
REV. NO.		DATE	DESCRIPTION OF REVISION	BY	APP	MATERIAL		SH. SIZE	B
						TITLE		Versa-Lok Panel Detail	
						DWG. NO.		DR	KRK
								DATE	8/8/16
								SCALE	X:X

ATAS INTERNATIONAL, INC
Allentown PA
610-395-8445
Mesa AZ
480-558-7210