

BOM per 12'	
Component	Quantity
Coping Cover	1
6" Splice	1
0.125" x 1" Alum. Hanger	6
.080 Alum. Internal Support Bracket	6
0.125" x 2" Alum. External Support	6
#10-13 x 1" Fastener	12
#10-12 x 2" Fastener	6

Standard Materials	
Materials	Available Gauges
Pre-Finished Steel	24 GA, 22 GA
Stainless Steel	24 GA, 22 GA
Pre-Finished Alum.	.040, .050, .063
Mill Alum.	.040, .050, .063

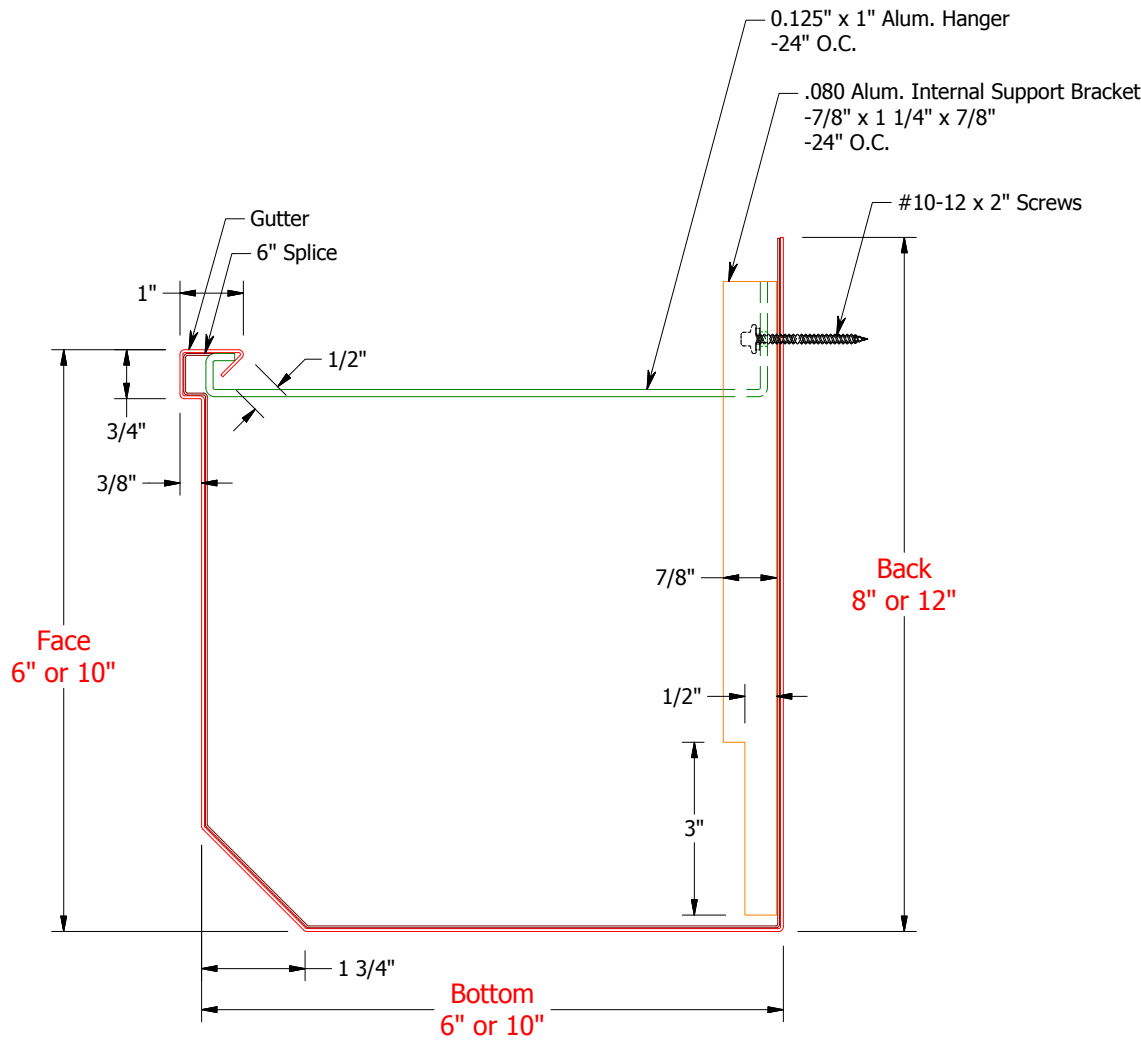
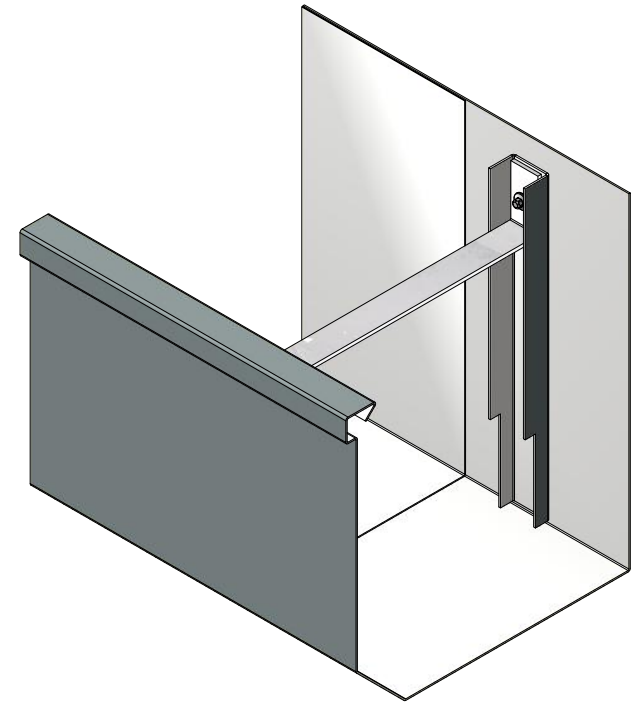

ATAS INTERNATIONAL, INC
 Allentown PA
 610-395-8445
 Mesa AZ
 480-558-7210

TITLE				Ultra High Performance Gutter Product Detail	
DWG. NO.		DR		DATE	
		PJR		01-20-17	
		APP		DATE	
MATERIAL				SH. SIZE	
				A	
				SCALE	
				X:X	
REV. NO.	DATE	DESCRIPTION OF REVISION	BY	APP	