

Vertical Panel

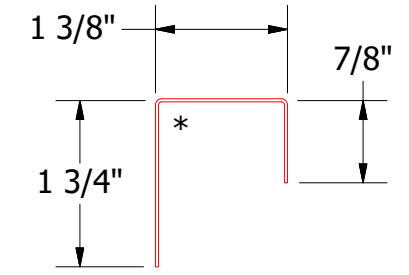

BPA270-J Closure

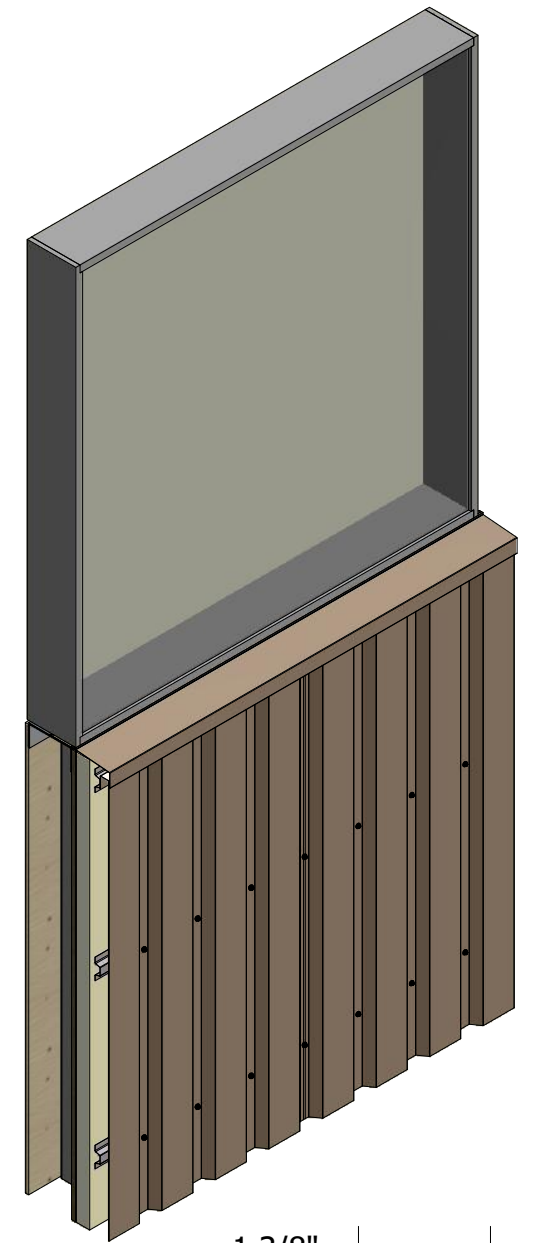
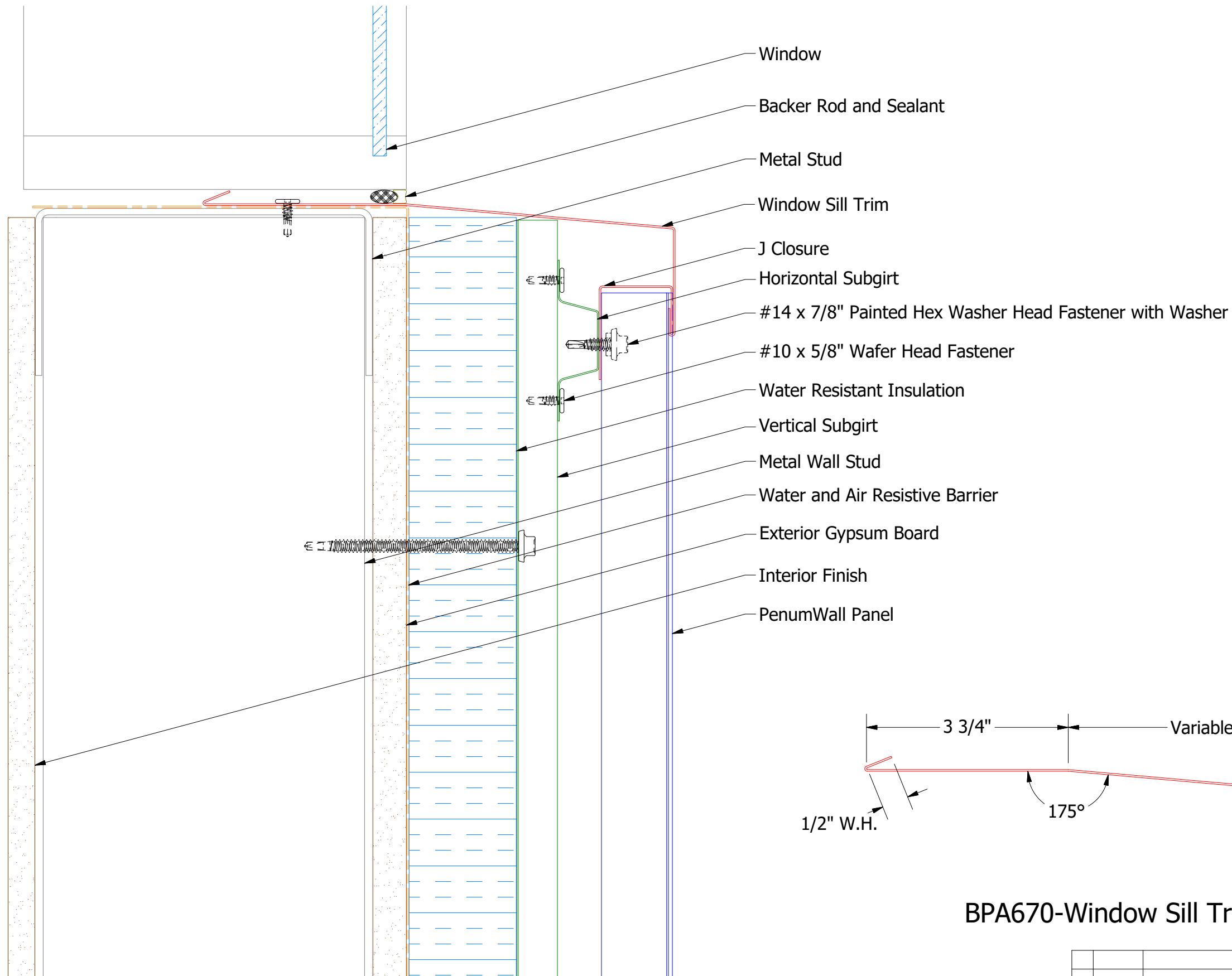
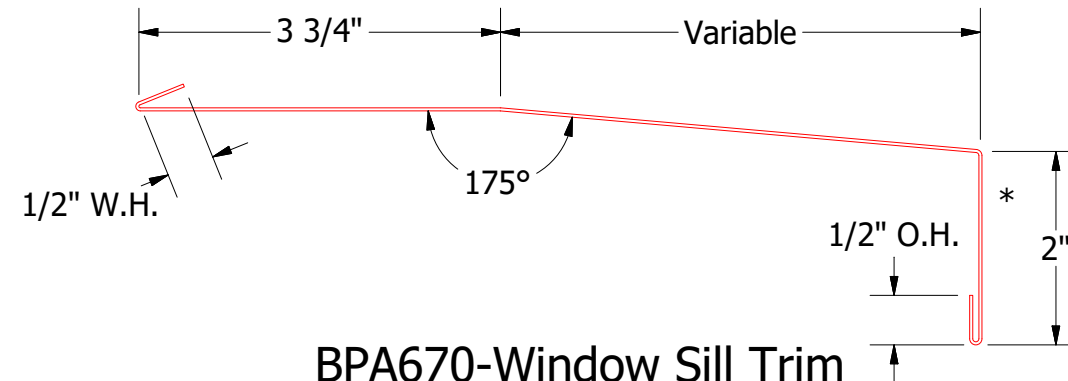

BPA670-Window Sill Trim

Note: * denotes color side.

ATAS ATAS INTERNATIONAL, INC
 Allentown PA
 610-395-8445
 Mesa AZ
 480-558-7210

TITLE				DR		DATE	
PenumWall Open Window Sill Detail				DWG. NO.	DR	DATE	4/24/2017
				APP	DMR	DATE	
				MATERIAL	SH. SIZE	SCALE	X:X
1	4/20/2021	Added color side note.	DMR		B		
REV. NO.	DATE	DESCRIPTION OF REVISION	BY	APP			