

ATAS International, Inc.

Sustainable Building Envelope Technology

RAPID-LOK ULTRA COPING

SPECIFICATION SHEET

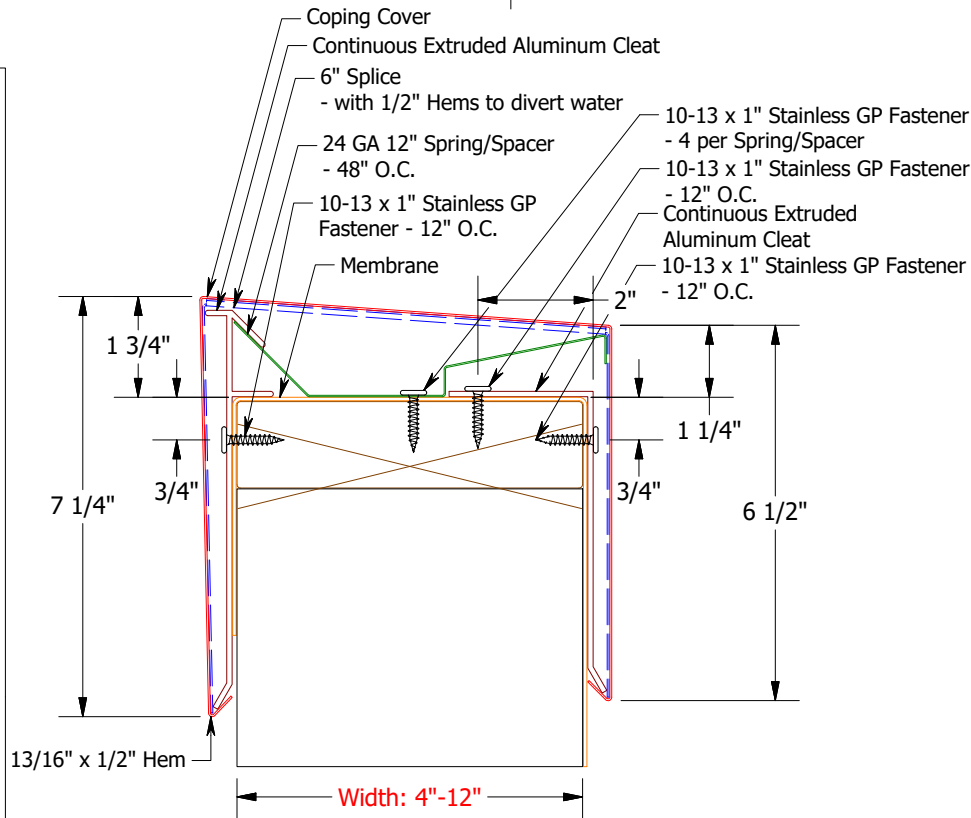
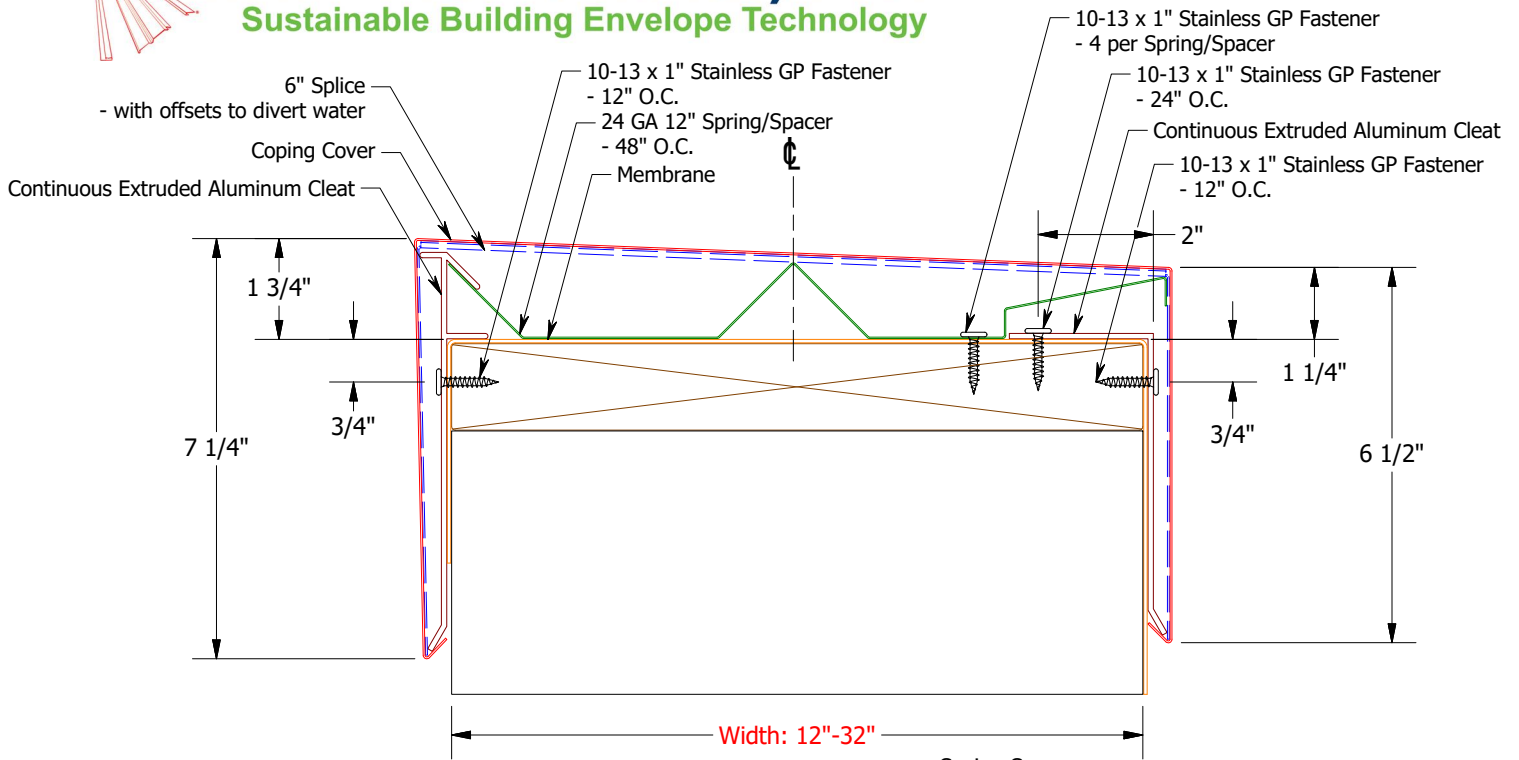

Quantity:

- ___ Total LF (12'-0" pcs)
___ Radius Coping LF (6'-0" pcs)
 (Radius: ____, Convex or Concave)
___ Vaulted Coping LF (6'-0" pcs)
 (Radius: ____, Convex or Concave)

Standard Accessories:

- ___ Inside Mitered Corner(s) (Angle: ____)
___ Outside Mitered Corner(s) (Angle: ____)
___ End Closure(s) (___ Left, ___ Right)
___ End Term(s) (___ Left, ___ Right)

Custom Accessories: (sketches required)

- Inline Transition(s) -Tee(s)
-Transition Miter(s) -Zee(s)
-Ridge Miter(s) -Special Miter(s)
-Valley Miter(s)

***All Components for installing Accessories are included.**

MATERIAL:

THICKNESS:

- Pre-Finished Aluminum .040 .050 .063
 Mill Finished Aluminum .040 .050 .063
 Pre-Finished Steel 24 ga 22 ga
 Stainless Steel 24 ga 22 ga

COLOR: _____

ANSI/SPRI ES-1 Tested

Projects Requirement's
Horizontal Design Pressure: _____ psf
Vertical Design Pressure: _____ psf

Job Name:	Customer:
Job #:	Representative:
Location:	Distributor:

CUSTOMER APPROVAL

Authorized Signature: _____

Approved by: _____

Date: _____