

16 - MDA911 - VENTED 'Z' CLOSURE

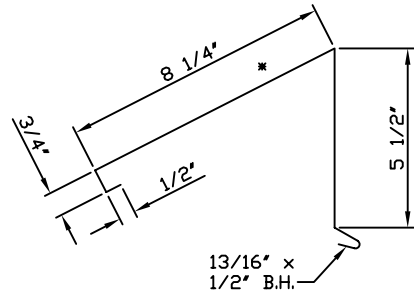

20 - MDA362 - VENTED SHED RIDGE CAP
 Roof slopes 3/12+ to 6/12
 Ridge splice to match ridge cap 6' long each; MDA363

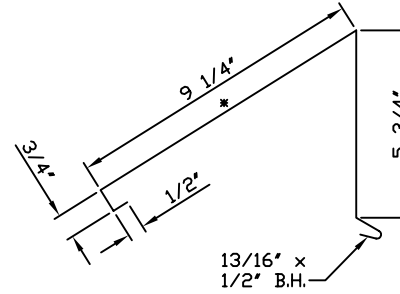

20 - MDA364 - VENTED SHED RIDGE CAP
 Roof slopes 6/12+ to 9/12
 Ridge splice to match ridge cap 6' long each; MDA365

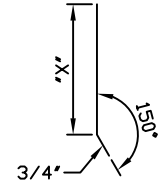

18 - MDA348 SHED RIDGE STARTER CLEAT
 Note: This part furnished in either 24 ga. steel or .032 aluminum. No specific color.
 Dimension 'X' is equal to the chosen #20's dimension 'C' minus 1/8\"/>

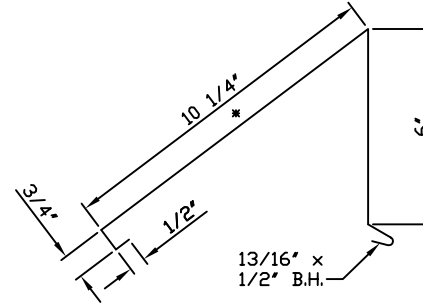
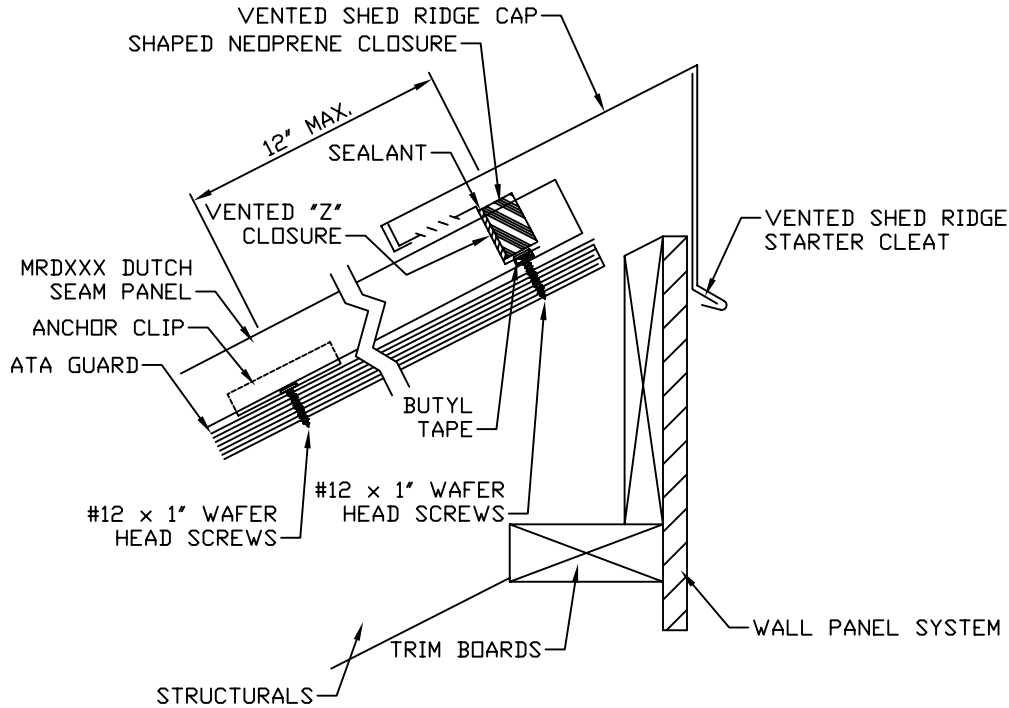

20 - MDA366 - VENTED SHED RIDGE CAP
 Roof slopes 9/12+ to 12/12
 Ridge splice to match ridge cap 6' long each; MDA367



ATAS INTERNATIONAL, INC.
 Allentown PA
 610-395-8445
 Mesa AZ
 480-558-7210

TITLE							MRD Vented Shed Ridge - Ply			
DWG NO. / FILE NO.				MRD Vented Shed Ridge - Ply			SCALE		3"=1'-0"	
DRAWN BY	DAS	DATE	3-6-06	APPR. BY	JEB	DATE	5-31-06			
REVISION NO.	XXXX	REVISION DATE	MM/DD/YY	APPR. BY	XXXX	APPR. DATE	MM/DD/YY			

Rev. No.	Revision Date	Drawn By	Description of Revision
0	5-31-06	DAS	MRD Vented Shed Ridge - Ply